

WEST BAY SANITARY DISTRICT

SAN MATEO COUNTY CALIFORNIA

ALPINE ROAD SANITARY SEWER REPLACEMENT PROJECT

GENERAL NOTES:

- THE FOLLOWING NOTES ARE ESTABLISHED MERELY TO GUIDE THE CONTRACTOR AS TO THE GENERAL ITEMS OF WORK INVOLVED AND ARE NOT INTENDED TO COVER COMPLETE SCOPE OF WORK. THE CONTRACTOR SHALL COMPLETE ALL WORK AS PER CONSTRUCTION PLANS AND SPECIFICATIONS.
- CONTRACTOR AGREES THAT THEY SHALL ASSUME SOLE AND COMPLETE RESPONSIBILITY FOR JOB SITE CONDITIONS DURING THE COURSE OF CONSTRUCTION OF THIS PROJECT, INCLUDING SAFETY OF ALL PERSONS AND PROPERTY; THAT THIS REQUIREMENT SHALL APPLY CONTINUOUSLY AND NOT BE LIMITED TO NORMAL WORKING HOURS; AND THAT THE CONTRACTOR SHALL DEFEND, INDEMNIFY AND HOLD THE OWNER AND THE ENGINEER HARMLESS FROM ANY AND ALL LIABILITY, REAL OR ALLEGED, IN CONNECTION WITH THE PERFORMANCE OF WORK ON THIS PROJECT, EXCEPT FOR LIABILITY ARISING FROM THE SOLE NEGLIGENCE OF THE OWNER OR THE ENGINEER.
- ALL SANITARY SEWERS SHALL BE CONSTRUCTED IN ACCORDANCE WITH THESE PLANS, THE SPECIAL TECHNICAL PROVISIONS AND THE STANDARD SPECIFICATIONS OF THE WEST BAY SANITARY DISTRICT. ALL WORK NOT SPECIFICALLY COVERED IN THE STANDARD SPECIFICATIONS OF WEST BAY SANITARY DISTRICT AND THE SPECIAL TECHNICAL PROVISIONS FOR THESE IMPROVEMENTS SHALL BE DONE IN ACCORDANCE WITH THE STATE OF CALIFORNIA, DEPARTMENT OF TRANSPORTATION SPECIFICATIONS, LATEST EDITION.
- THE WORK SHOWN ON THESE PLANS IS WITHIN THE JURISDICTION OF THE CITY OF PORTOLA VALLEY, AND SHALL BE PERFORMED IN ACCORDANCE WITH THE PROVISIONS AND THE REQUIREMENTS OF THE ENCROACHMENT PERMITS.
- THE LOCATIONS AND TYPES OF EXISTING UTILITIES SHOWN ON THE IMPROVEMENT PLANS ARE BASED ON INFORMATION FURNISHED BY SERVING AGENCIES AND IS TO BE SUPPLEMENTED BY ACTUAL FIELD INVESTIGATION AND VERIFICATIONS BY CONTRACTOR. ATTENTION IS DIRECTED TO VERIFICATIONS OF DEPTHS AND EXACT LOCATIONS OF EXISTING SERVICES WHETHER SHOWN ON THE PLAN OR NOT AND THE CONTRACTOR SHALL TAKE PRECAUTIONARY MEASURES TO PRESERVE AND AVOID DAMAGES TO EXISTING UTILITIES ENCOUNTERED. NOTE: EXISTING UTILITY SERVICES TO HOUSES ARE NOT SHOWN ON THE PLANS. CONTRACTOR SHALL NOTIFY PG&E, AT&T, CALIFORNIA WATER AND UNDERGROUND SERVICE ALERT (USA) AT (800) 642-2444, PRIOR TO ANY FIELD INVESTIGATION.
- BEDDING MATERIAL SHALL BE AN IMPORTED VIRGIN GRANULAR MATERIAL FREE FROM VEGETABLE MATTER AND OTHER ORGANIC SUBSTANCES AND SHALL BE OF SUCH NATURE THAT IT CAN BE COMPACTED READILY UNDER WATERING, ROLLING AND TAMPING TO FORM A FIRM AND STABLE BASE. BEDDING MATERIAL SHALL CONFORM TO THE GRADATION REQUIREMENTS SHOWN ON THE DETAIL DRAWING.
- RELATIVE COMPACTION AND IN-PLACE DENSITY SHALL BE DETERMINED AS DEFINED BY THE TEST METHOD OF ASTM D1557.
- EXISTING FLOWS MUST BE MAINTAINED BY CONTRACTOR AT ALL TIMES DURING CONSTRUCTION. CONTRACTOR SHALL NOTIFY PROPERTY OWNERS OF ANY INTERRUPTION OF SEWER SERVICES PRIOR TO ANY WORK ON EXISTING SEWER PIPES. SEWAGE FLOWS SHALL BE MAINTAINED BY PUMPING.
- ALL EXISTING IMPROVEMENTS, INCLUDING BUT NOT LIMITED TO LANDSCAPING, DRIVEWAYS, CURB, GUTTER, SIDEWALK, CULVERTS, DRAINS, STRIPING (PAINTED OR THERMOPLASTIC) AND MONUMENTS, SHALL BE RESTORED TO THE CONDITION IN WHICH THEY WERE OR BETTER BEFORE THE EXCAVATION WAS MADE. PAYMENT FOR RESTORATION OF EXISTING IMPROVEMENTS TO THEIR ORIGINAL CONDITION WILL NOT BE MADE AND SHALL BE CONSIDERED AS INCLUDED IN THE VARIOUS CONTRACT ITEMS OF WORK INVOLVED.
- THE CONTRACTOR SHALL COMPLY WITH ALL RELEVANT PROVISIONS OF FEDERAL, STATE, AND LOCAL CODES AND REGULATIONS IN REGARD TO TRAFFIC CONTROL. THE CONTRACTOR SHALL SUBMIT A TRAFFIC CONTROL PLAN PRIOR TO THE START OF WORK TO BE APPROVED BY THE DISTRICT AND THE LOCAL JURISDICTION.
- THE CONTRACTOR SHALL CONDUCT THEIR OPERATION AS TO OFFER THE LEAST POSSIBLE OBSTRUCTION AND INCONVENIENCE TO THE PUBLIC. THROUGHOUT THE PERFORMANCE OF THE WORK, OR IN CONNECTION TO THIS CONTRACT, THE CONTRACTOR SHALL CONSTRUCT AND ADEQUATELY MAINTAIN SUITABLE AND SAFE CROSSINGS OVER TRENCHES, DRIVEWAY ACCESS AND SUCH DETOURS AS ARE NECESSARY TO CARE FOR PUBLIC PEDESTRIAN TRAFFIC.
- CONTRACTOR SHALL CONFORM TO ALL APPLICABLE OSHA RULES, REGULATIONS, AND ORDERS ESTABLISHED BY FEDERAL AND STATE AGENCIES BEFORE ENTERING SANITARY SEWER MANHOLES.
- IF THE CONTRACTOR PLANS TO USE MACHINERY WITH TRACKS, PLYWOOD SHALL BE PLACED IN FRONT AND/OR BACK OF THE MACHINE (DEPENDING ON THE TRAVEL DIRECTION), SO THAT SURFACE DESTRUCTION IS AVOIDED. ANY SURFACE DESTRUCTION SHALL BE REPAIRED BY THE CONTRACTOR AT NO COST TO THE DISTRICT, TO THE SATISFACTION OF THE LOCAL JURISDICTION.
- THE REPLACEMENT OF SEWER MAINS SHALL BE CONSTRUCTED AT THE DESIGNED HORIZONTAL ALIGNMENT AND THE PROPOSED GRADE (DEPTH) AS SHOWN ON THE PLANS. THE EXISTING SEWER MAINS SHALL BE USED AS STATIONING CONTROL LINE. THE CONTRACTOR SHOULD BE ALERTED TO THE NEED FOR EXCAVATION BELOW EXISTING PIPE INVERT FOR PLACEMENT OF BEDDING MATERIALS AS SHOWN ON THE DETAIL DRAWINGS.
- CONCRETE FOR MANHOLES SHALL MEET THE REQUIREMENTS OF CLASS 1 CONCRETE AS DEFINED IN CALTRANS STANDARD SPECIFICATIONS, LATEST EDITION.
- CONTRACTOR SHALL PROVIDE PUMPS OR OTHER MEANS TO PREVENT SEWER WASTE BACKUP DUE TO THEIR WORK ON THE EXISTING SEWERS. CONTRACTOR SHALL BE RESPONSIBLE FOR CLEANUP AND DAMAGES CAUSED BY THEIR NEGLIGENCE, AND SHALL PAY ANY FINES DUE TO THEIR NEGLIGENCE.
- PRIOR TO THE START OF SEWER CONSTRUCTION, THE CONTRACTOR SHALL PERFORM BYPASSING OPERATIONS. CONSTRUCTION CAN NOT BEGIN UNTIL BYPASSING OPERATIONS ARE APPROVED BY THE DISTRICT.
- THE CONTRACTOR SHALL AT ALL TIMES HAVE AT THE JOB SITE SUFFICIENT PUMPING MACHINERY READY FOR IMMEDIATE USE. THE TRENCHES AND EXCAVATIONS SHALL BE KEPT ENTIRELY FREE OF WATER WHILE CONCRETE IS BEING POURED OR PIPE IS BEING LAID AND UNTIL CONCRETE OR MORTAR HAS SET HARD. WATER SHALL BE DISPOSED OF IN SUCH A MANNER AS WILL NOT CAUSE INJURY TO PUBLIC OR PRIVATE PROPERTY, NOR BE A MENACE TO PUBLIC HEALTH.
- ALL PROPERTY LINES SHOWN ARE APPROXIMATED FROM ASSESSORS PARCEL MAPS OR FROM RECORD INFORMATION, AND THEIR LOCATION MAY NOT BE EXACT. THE PROPERTY LINES SHALL BE USED AS REFERENCE TO LOCATE SERVICE LATERAL CONNECTION TO EACH PROPERTY. IT IS THE CONTRACTOR'S RESPONSIBILITY TO LOCATE THE EXACT LOCATION OF EACH PROPERTY LATERAL FOR CONNECTION.
- THE NUMBER OF LATERALS SHOWN ON THE PLANS IS BASED ON T.V. INVESTIGATION LOGS, WHICH MAY INCLUDE BOTH LIVE AND DEAD LATERALS. FINAL NUMBERS TO BE USED FOR PAYMENT IS THE NUMBER OF LIVE LATERALS CONNECTED. THE CONTRACTOR SHALL SAWCUT THE ABANDONED LATERALS AT THE EDGE OF THE TRENCH AND PLUG THEM IN ACCORDANCE WITH THE DISTRICT'S STANDARDS.
- THE CONTRACTOR WILL NOTIFY AFFECTED RESIDENTS OR BUSINESSES OF THE PROPOSED WORK WITH THE FIRST NOTICES BEING DISTRIBUTED AS SOON AS THE PROJECT IS AWARDED.

UNAUTHORIZED CHANGES & USES: The engineer preparing these plans will not be responsible for, or liable for, unauthorized changes to or uses of these plans. All changes to the plans must be in writing and must be approved by the preparer of these plans.

Construction contractor agrees that in accordance with generally accepted construction practices, construction contractor will be required to assume sole and complete responsibility for job site conditions during the course of construction of the project, including safety of all persons and property; that this requirement shall be made to apply continuously and not be limited to normal working hours, and construction contractor further agrees to defend, indemnify and hold design professional harmless from any and all liability, real or alleged, in connection with the performance of work on this project, excepting liability arising from the sole negligence of design professional.

BOARD OF DIRECTORS

EDWARD P. MORITZ	PRESIDENT
FRAN DEHN	SECRETARY
ROY THIELE-SARDIÑA	TREASURER
DAVID WALKER	DIRECTOR
GEORGE OTTE	DIRECTOR
PHIL SCOTT	DISTRICT MANAGER

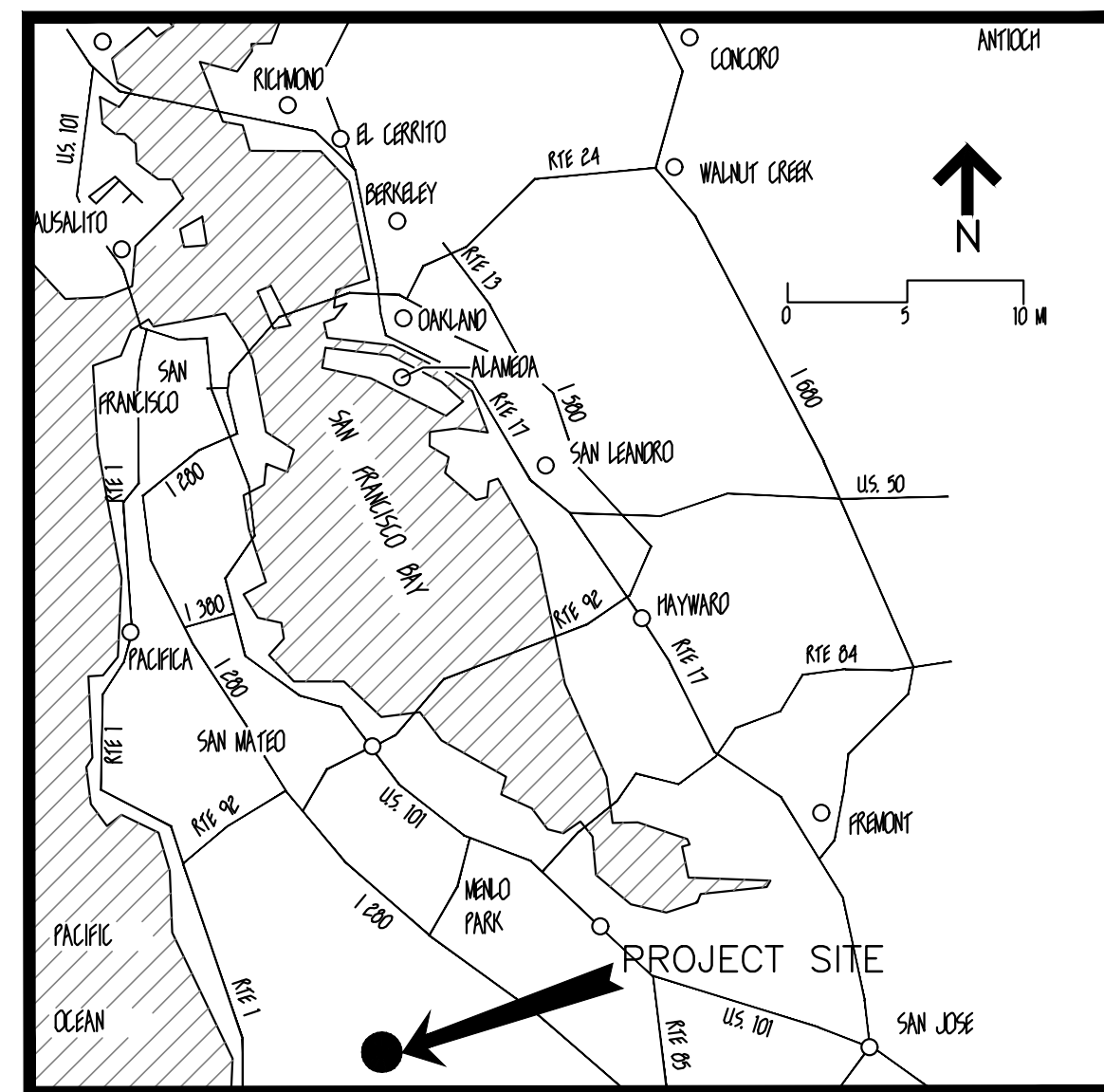

REGIONAL LOCATION NTS

LEGEND

	SANITARY SEWER TO BE INSTALLED		EXISTING COMMUNICATIONS LINE
	EXISTING SANITARY SEWER		STRIPED EDGE OF TRAVELWAY
	EXISTING LATERAL		EXISTING WATER VALVE
	EXISTING GAS LINE		EXISTING WATER METER
	EXISTING ELECTRICAL LINE OVER HEAD		EXISTING CLEAN OUT
	EXISTING WATER LINE		EXISTING FIRE HYDRANT
	EXISTING ELECTRICAL LINE		EXISTING SEWER/ STORM DRAIN MANHOLE
	EXISTING STORM DRAIN		EXISTING ELECTRICAL PULL BOX
	ROLLED CURB AND GUTTER		EXISTING CATCH BASIN
	CURB AND GUTTER		TRAFFIC SIGN
	EXISTING COMMUNICATION LINE		EXISTING BUILDING/STRUCTURE
	EXISTING UTILITY EASEMENT		EXISTING MONUMENT

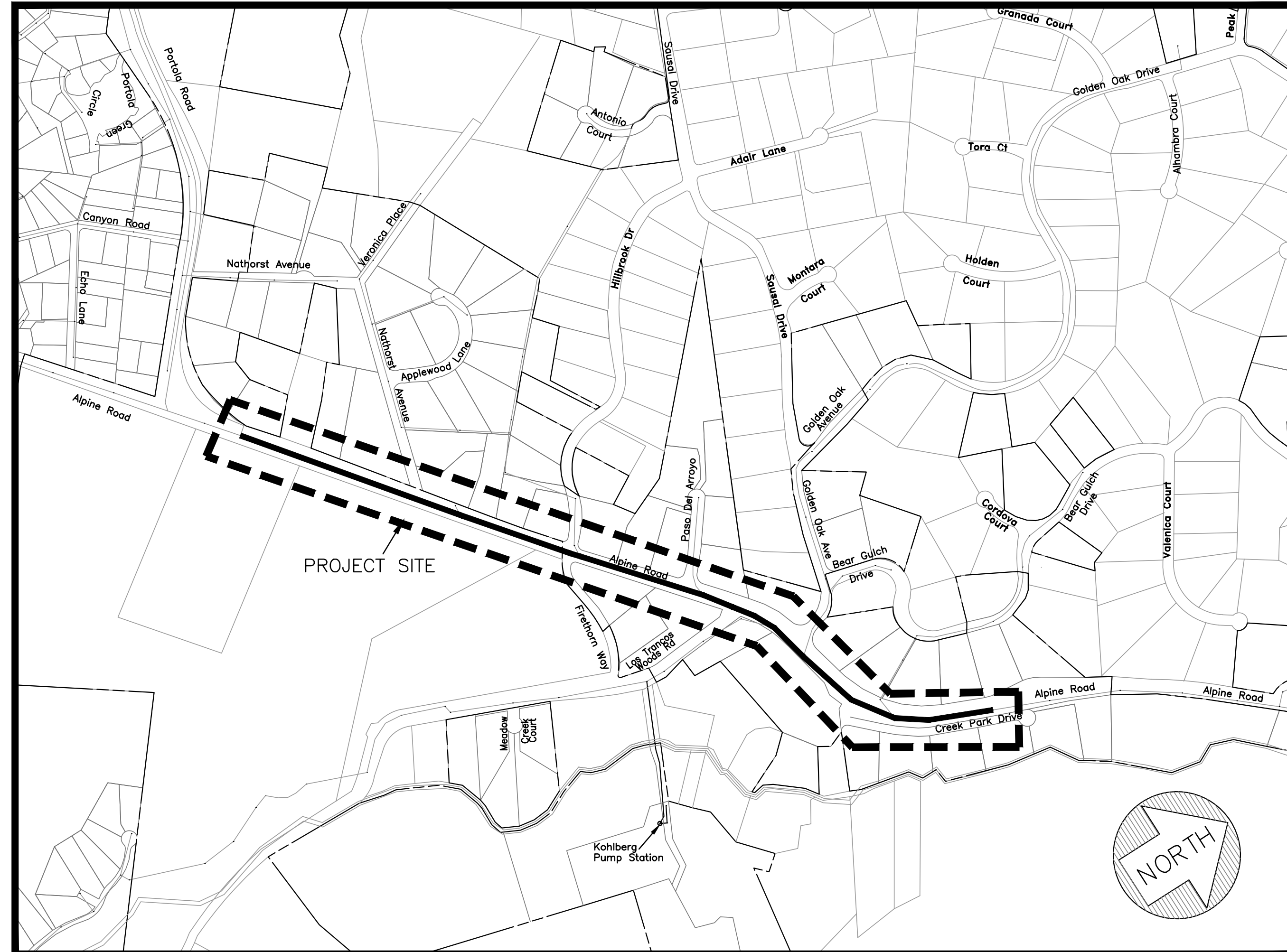

ALPINE ROAD VICINITY LOCATION NTS

INDEX OF DRAWINGS

SHEET #	DESCRIPTION	SHEET #	DESCRIPTION
1	COVER SHEET	8	PLAN & PROFILE - ALPINE ROAD STA: 31+50 - 36+50
2	PLAN & PROFILE - ALPINE ROAD STA: 0+00 - 5+00	9	PLAN & PROFILE - ALPINE ROAD STA: 36+50 - 38+98
3	PLAN & PROFILE - ALPINE ROAD STA: 5+00 - 10+00	10	DETAIL SHEET #1
4	PLAN & PROFILE - ALPINE ROAD STA: 10+00 - 15+50	11	CONSTRUCTION BEST MANAGEMENT PRACTICES
5	PLAN & PROFILE - ALPINE ROAD STA: 15+50 - 21+00		
6	PLAN & PROFILE - ALPINE ROAD STA: 21+00 - 26+50		
7	PLAN & PROFILE - ALPINE ROAD STA: 26+50 - 31+50		

DATE:	09/11/18	09/14/18	ISSUED FOR BID
SCALE:	AS NOTED		
DESIGNED:	RQL		
DRAWN:	RQL		
CHECKED:	JL		
PROJ. ENGR:	RJL		
BY	DATE	DESCRIPTION OF REVISIONS	APP'D

FL FREYER & LAURETA, INC.
CIVIL ENGINEERS • SURVEYORS • CONSTRUCTION MANAGERS

144 North San Mateo Drive • San Mateo, CA 94401
(650)344-9901 • Fax (650)344-9920 • www.freyerlaureta.com

WEST BAY SANITARY DISTRICT
SAN MATEO COUNTY

PROJECT No. 1758.9

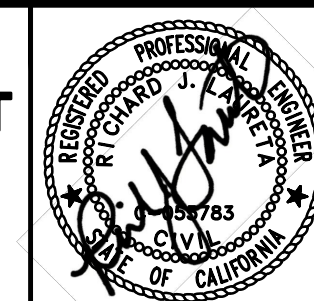

ALPINE ROAD SANITARY SEWER REPLACEMENT PROJECT
COVER SHEET
PORTOLA VALLEY, CALIFORNIA

SHEET
1
JOB NO.
1080

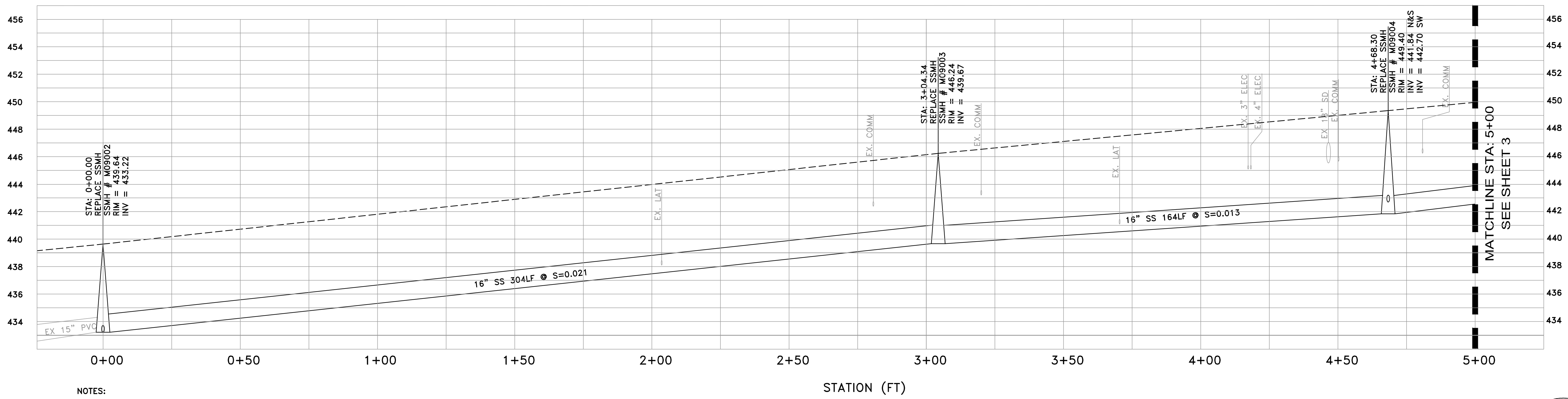
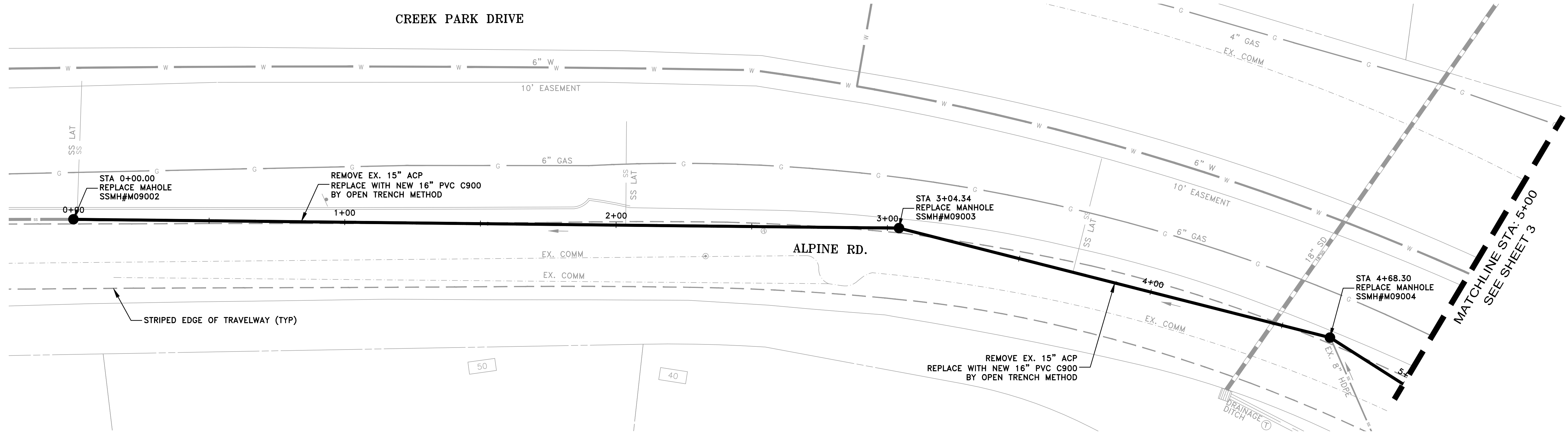

NOTES:

- 1) CONTRACTOR SHALL BE RESPONSIBLE FOR THE UNINTERRUPTION OF SEWER SERVICE FOR ALL PROPERTIES. CONTRACTOR SHALL SUBMIT BYPASS PLAN TO THE DISTRICT FOR APPROVAL 10 DAYS PRIOR TO THE PRE-CONSTRUCTION MEETING.
- 2) CONTRACTOR SHALL TAKE ALL NECESSARY PRECAUTIONS TO AVOID ANY DAMAGE TO EXISTING UTILITIES. CONTRACTOR SHALL NOTE THE CLOSE PROXIMITY OF UTILITIES TO PROPOSED IMPROVEMENTS. CONTRACTOR SHALL NOTIFY U.S.A. TO LOCATE UTILITIES AT THE PROJECT SITE PRIOR TO START OF CONSTRUCTION.
- 3) ALL LATERALS AND THEIR LOCATION MAY NOT BE EXACT AS THEY ARE REFERENCED FROM INFORMATION GIVEN BY WBSD. IT IS THE CONTRACTOR'S RESPONSIBILITY TO LOCATE THE EXACT LOCATION OF EACH PROPERTY LATERAL FOR CONNECTION.
- 4) ALL PROPERTY LINES SHOWN ARE APPROXIMATE.

PROFILE VIEW
 HORIZ: 1" = 20'
 VERT: 1" = 4'

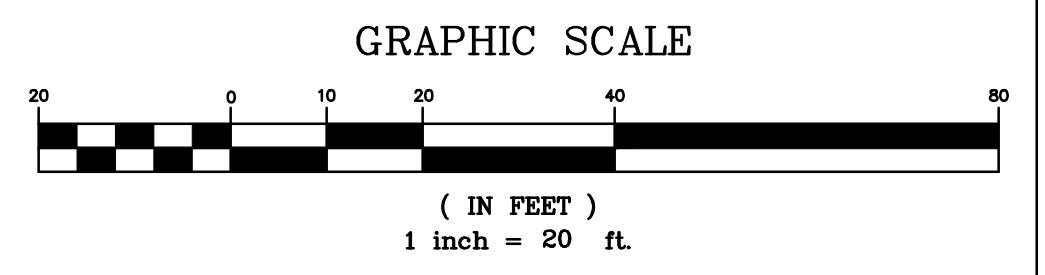
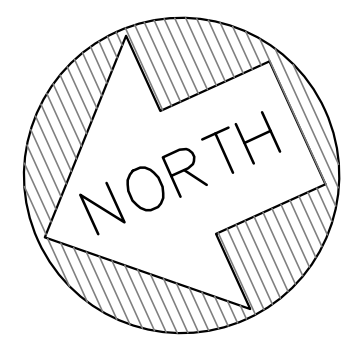

DATE:	09/11/18	09/14/18	ISSUED FOR BID
SCALE:	AS NOTED		
DESIGNED:	RQL		
DRAWN:	RQL		
CHECKED:	JL		
PROJ. ENGR:	RJL		
BY	DATE	DESCRIPTION OF REVISIONS	APP'D

FL FREYER & LAURETA, INC.
 CIVIL ENGINEERS • SURVEYORS • CONSTRUCTION MANAGERS

144 North San Mateo Drive • San Mateo, CA 94401
 (650)344-9901 • Fax (650)344-9920 • www.freyerlaureta.com

WEST BAY SANITARY DISTRICT
 SAN MATEO COUNTY
 PROJECT No. 1758.9



ALPINE ROAD SANITARY SEWER REPLACEMENT PROJECT
PLAN & PROFILE ALPINE ROAD
STA 0+00 TO 5+00
PORTOLA VALLEY, CALIFORNIA

SHEET	2
JOB NO.	1080

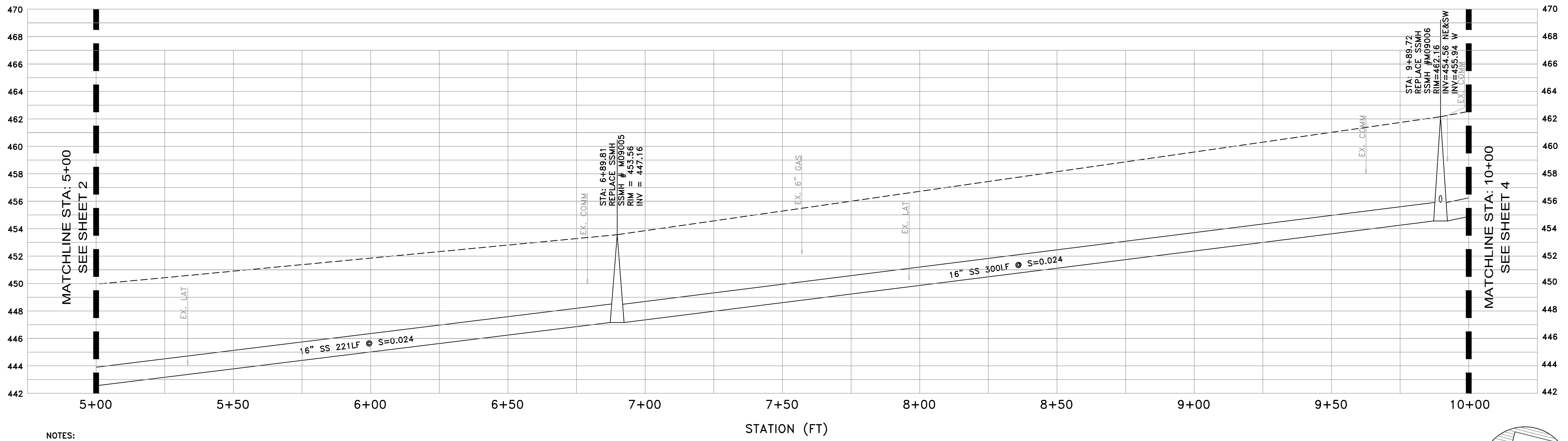
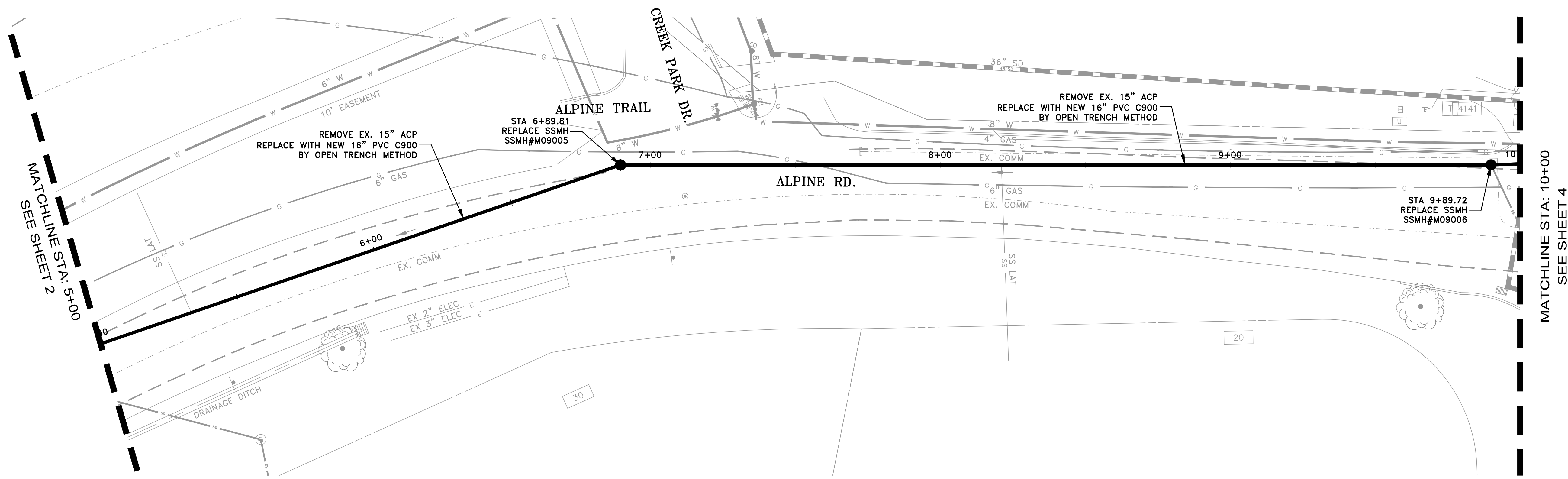

NOTES:

- 1) CONTRACTOR SHALL BE RESPONSIBLE FOR THE UNINTERRUPTION OF SEWER SERVICE FOR ALL PROPERTIES. CONTRACTOR SHALL SUBMIT BYPASS PLAN TO THE DISTRICT FOR APPROVAL 10 DAYS PRIOR TO THE PRE-CONSTRUCTION MEETING.
- 2) CONTRACTOR SHALL TAKE ALL NECESSARY PRECAUTIONS TO AVOID ANY DAMAGE TO EXISTING UTILITIES. CONTRACTOR SHALL NOTE THE CLOSE PROXIMITY OF UTILITIES TO PROPOSED IMPROVEMENTS. CONTRACTOR SHALL NOTIFY U.S.A. TO LOCATE UTILITIES AT THE PROJECT SITE PRIOR TO START OF CONSTRUCTION.
- 3) ALL LATERALS AND THEIR LOCATION MAY NOT BE EXACT AS THEY ARE REFERENCED FROM INFORMATION GIVEN BY WBSD. IT IS THE CONTRACTOR'S RESPONSIBILITY TO LOCATE THE EXACT LOCATION OF EACH PROPERTY LATERAL FOR CONNECTION.
- 4) ALL PROPERTY LINES SHOWN ARE APPROXIMATE.

PROFILE VIEW
 HORIZ: 1" = 20'
 VERT: 1" = 4'

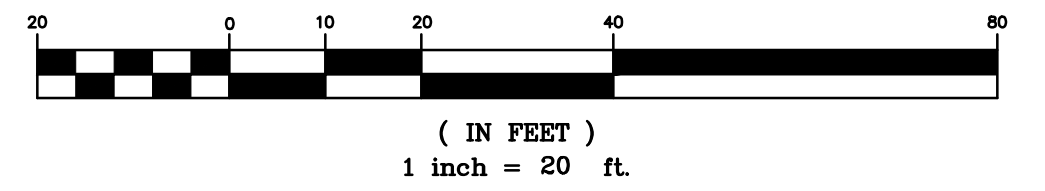
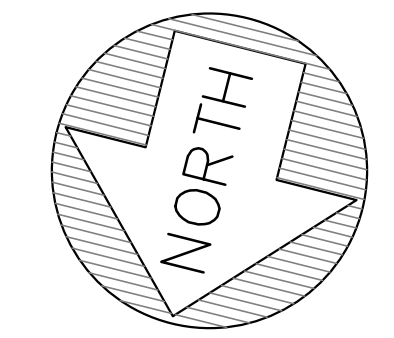

DATE:	09/11/18	09/14/18	ISSUED FOR BID
SCALE:	AS NOTED		
DESIGNED:	RQL		
DRAWN:	RQL		
CHECKED:	JL		
PROJ. ENGR:	RJL		
BY	DATE	DESCRIPTION OF REVISIONS	APP'D

FL FREYER & LAURETA, INC.
 CIVIL ENGINEERS • SURVEYORS • CONSTRUCTION MANAGERS

144 North San Mateo Drive • San Mateo, CA 94401
 (650)344-9901 • Fax (650)344-9920 • www.freyerlaureta.com

WEST BAY
SANITARY DISTRICT
 SAN MATEO COUNTY
 PROJECT No. 1758.9



ALPINE ROAD SANITARY
SEWER REPLACEMENT PROJECT
PLAN & PROFILE ALPINE ROAD
STA 5+00 TO 10+00
PORTOLA VALLEY, CALIFORNIA

SHEET
3
 JOB No.
1080

MATCHLINE STA: 10+00
SEE SHEET 3

MATCHLINE STA: 15+50
SEE SHEET 5

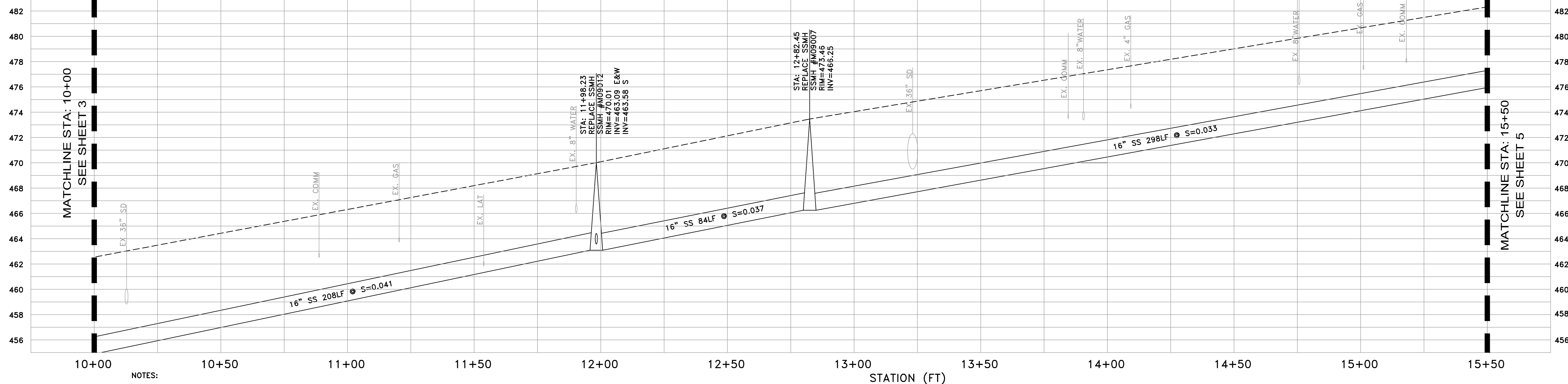
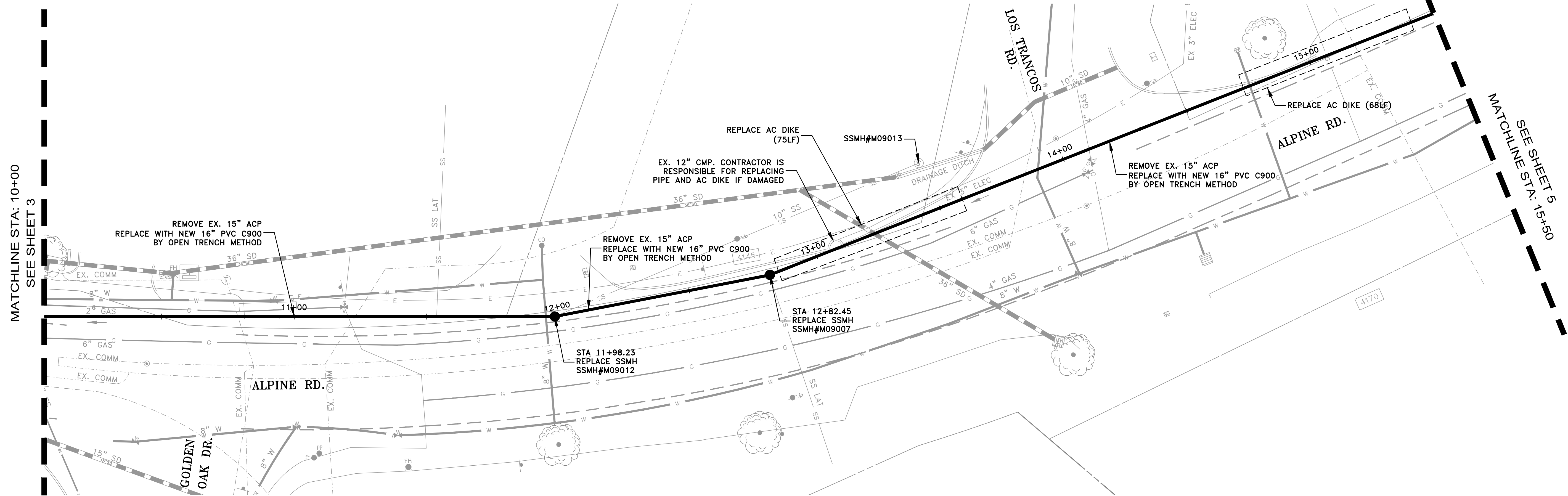

- NOTES:
- 1) CONTRACTOR SHALL BE RESPONSIBLE FOR THE UNINTERRUPTION OF SEWER SERVICE FOR ALL PROPERTIES. CONTRACTOR SHALL SUBMIT BYPASS PLAN TO THE DISTRICT FOR APPROVAL 10 DAYS PRIOR TO THE PRE-CONSTRUCTION MEETING.
 - 2) CONTRACTOR SHALL TAKE ALL NECESSARY PRECAUTIONS TO AVOID ANY DAMAGE TO EXISTING UTILITIES. CONTRACTOR SHALL NOTE THE CLOSE PROXIMITY OF UTILITIES TO PROPOSED IMPROVEMENTS. CONTRACTOR SHALL NOTIFY U.S.A. TO LOCATE UTILITIES AT THE PROJECT SITE PRIOR TO START OF CONSTRUCTION.
 - 3) ALL LATERALS AND THEIR LOCATION MAY NOT BE EXACT AS THEY ARE REFERENCED FROM INFORMATION GIVEN BY WBSD. IT IS THE CONTRACTOR'S RESPONSIBILITY TO LOCATE THE EXACT LOCATION OF EACH PROPERTY LATERAL FOR CONNECTION.
 - 4) ALL PROPERTY LINES SHOWN ARE APPROXIMATE.

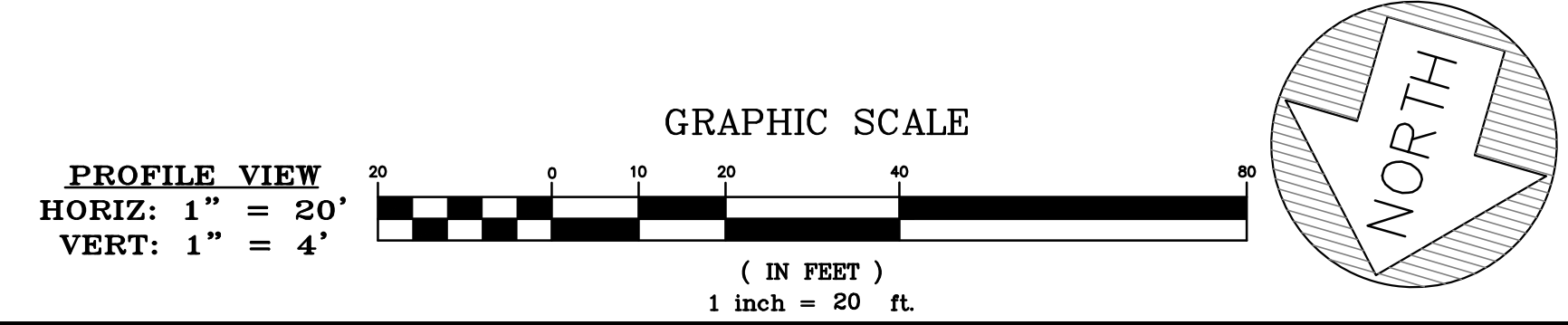

DATE:	09/11/18	09/14/18	ISSUED FOR BID
SCALE:	AS NOTED		
DESIGNED:	RQL		
DRAWN:	RQL		
CHECKED:	JL		
PROJ. ENGR:	RJL		
BY	DATE	DESCRIPTION OF REVISIONS	APP'D

FREYER & LAURETA, INC.
CIVIL ENGINEERS • SURVEYORS • CONSTRUCTION MANAGERS

144 North San Mateo Drive • San Mateo, CA 94401
(650)344-9901 • Fax (650)344-9920 • www.freyerlaureta.com

WEST BAY
SANITARY DISTRICT
SAN MATEO COUNTY
PROJECT No. 1758.9



ALPINE ROAD SANITARY
SEWER REPLACEMENT PROJECT
PLAN & PROFILE ALPINE ROAD
STA 10+00 TO 15+50
PORTOLA VALLEY, CALIFORNIA

SHEET
4
JOB No.
1080

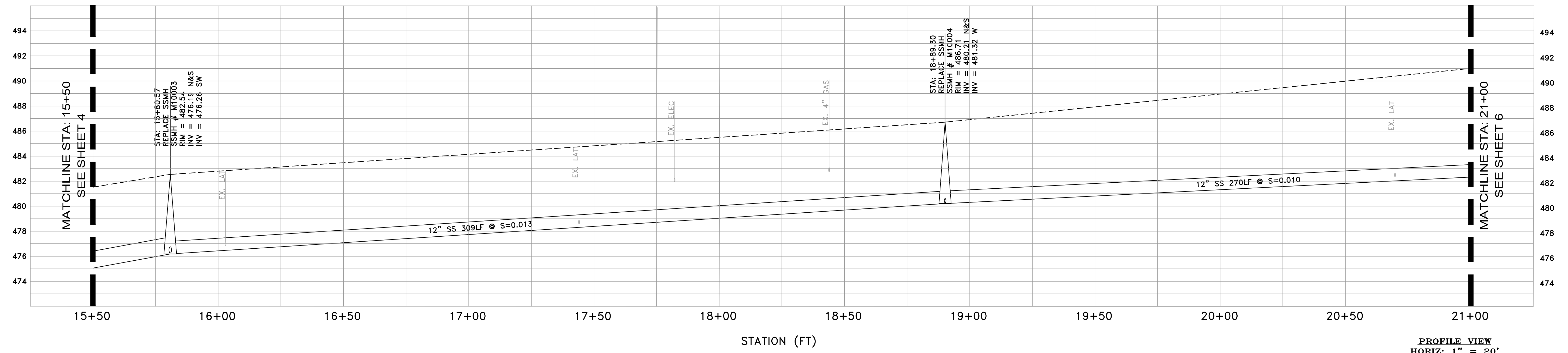
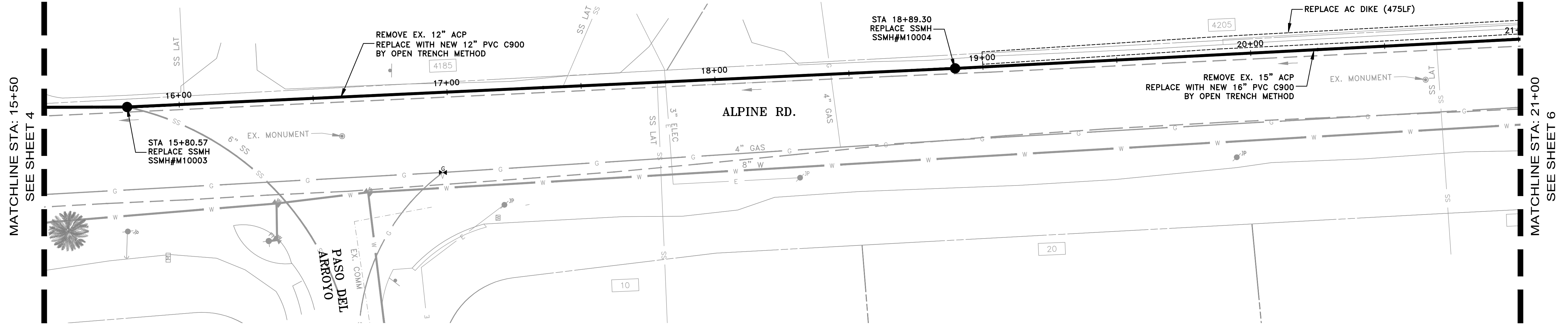

PROFILE VIEW
 HORIZ: 1" = 20'
 VERT: 1" = 4'

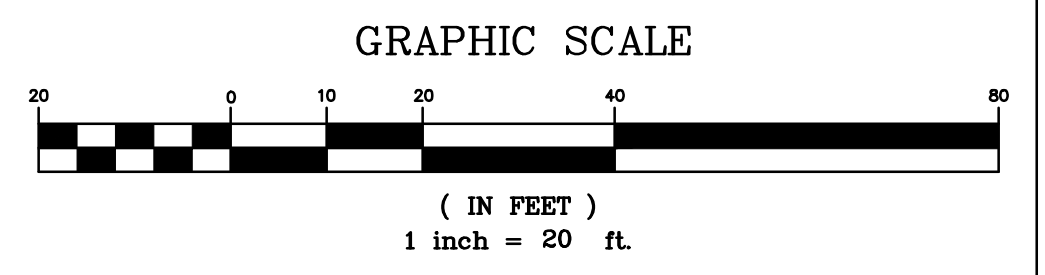
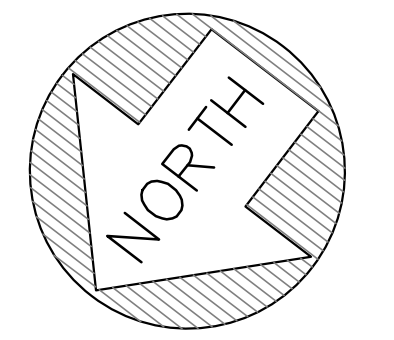

NOTES:

- 1) CONTRACTOR SHALL BE RESPONSIBLE FOR THE UNINTERRUPTION OF SEWER SERVICE FOR ALL PROPERTIES. CONTRACTOR SHALL SUBMIT BYPASS PLAN TO THE DISTRICT FOR APPROVAL 10 DAYS PRIOR TO THE PRE-CONSTRUCTION MEETING.
- 2) CONTRACTOR SHALL TAKE ALL NECESSARY PRECAUTIONS TO AVOID ANY DAMAGE TO EXISTING UTILITIES. CONTRACTOR SHALL NOTE THE CLOSE PROXIMITY OF UTILITIES TO PROPOSED IMPROVEMENTS. CONTRACTOR SHALL NOTIFY U.S.A. TO LOCATE UTILITIES AT THE PROJECT SITE PRIOR TO START OF CONSTRUCTION.
- 3) ALL LATERALS AND THEIR LOCATION MAY NOT BE EXACT AS THEY ARE REFERENCED FROM INFORMATION GIVEN BY WBSD. IT IS THE CONTRACTOR'S RESPONSIBILITY TO LOCATE THE EXACT LOCATION OF EACH PROPERTY LATERAL FOR CONNECTION.
- 4) ALL PROPERTY LINES SHOWN ARE APPROXIMATE.

DATE:	09/11/18	09/14/18	ISSUED FOR BID	
SCALE:	AS NOTED			
DESIGNED:	RQL			
DRAWN:	RQL			
CHECKED:	JL			
PROJ. ENGR:	RJL			
BY	DATE	DESCRIPTION OF REVISIONS	APP'D	

FL FREYER & LAURETA, INC.
 CIVIL ENGINEERS • SURVEYORS • CONSTRUCTION MANAGERS

144 North San Mateo Drive • San Mateo, CA 94401
 (650)344-9901 • Fax (650)344-9920 • www.freyerlaureta.com

WEST BAY
 SANITARY DISTRICT
 SAN MATEO COUNTY
 PROJECT No. 1758.9



**ALPINE ROAD SANITARY
 SEWER REPLACEMENT PROJECT
 PLAN & PROFILE ALPINE ROAD
 STA 15+50 TO 21+00
 PORTOLA VALLEY, CALIFORNIA**

SHEET
5
 JOB NO.
1080

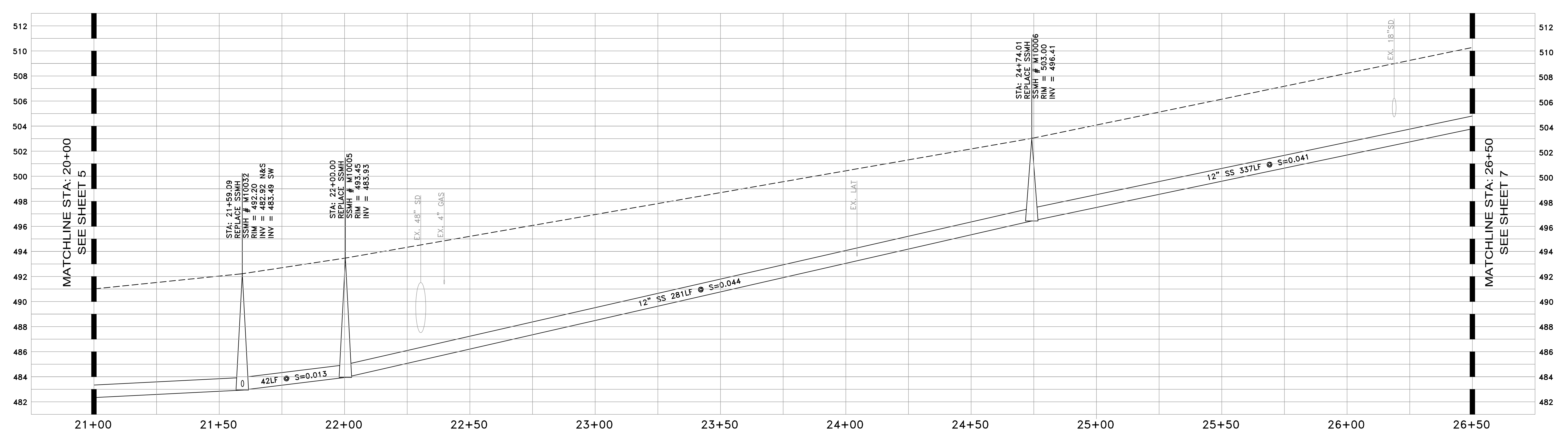
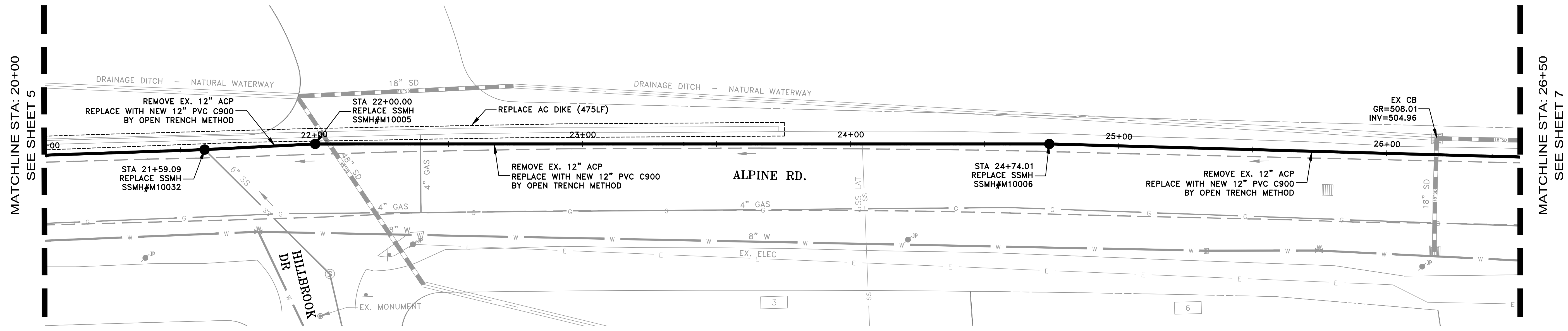

- NOTES:
- 1) CONTRACTOR SHALL BE RESPONSIBLE FOR THE UNINTERRUPTION OF SEWER SERVICE FOR ALL PROPERTIES. CONTRACTOR SHALL SUBMIT BYPASS PLAN TO THE DISTRICT FOR APPROVAL 10 DAYS PRIOR TO THE PRE-CONSTRUCTION MEETING.
 - 2) CONTRACTOR SHALL TAKE ALL NECESSARY PRECAUTIONS TO AVOID ANY DAMAGE TO EXISTING UTILITIES. CONTRACTOR SHALL NOTE THE CLOSE PROXIMITY OF UTILITIES TO PROPOSED IMPROVEMENTS. CONTRACTOR SHALL NOTIFY U.S.A. TO LOCATE UTILITIES AT THE PROJECT SITE PRIOR TO START OF CONSTRUCTION.
 - 3) ALL LATERALS AND THEIR LOCATION MAY NOT BE EXACT AS THEY ARE REFERENCED FROM INFORMATION GIVEN BY WBSD. IT IS THE CONTRACTOR'S RESPONSIBILITY TO LOCATE THE EXACT LOCATION OF EACH PROPERTY LATERAL FOR CONNECTION.
 - 4) ALL PROPERTY LINES SHOWN ARE APPROXIMATE.

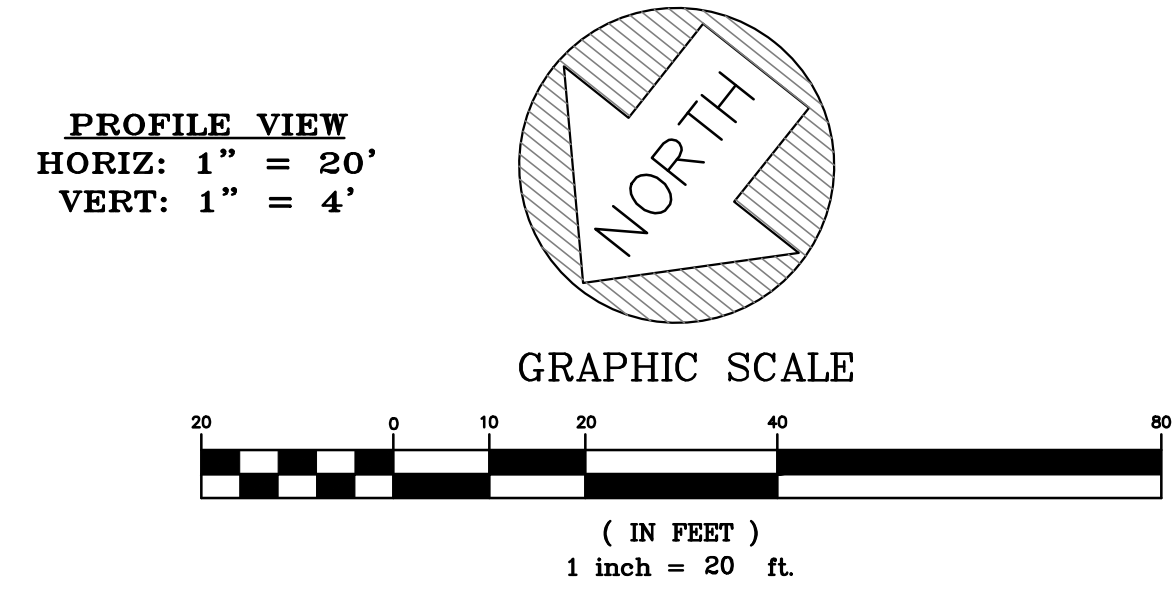

DATE:	09/11/18	09/14/18	ISSUED FOR BID
SCALE:	AS NOTED		
DESIGNED:	RQL		
DRAWN:	RQL		
CHECKED:	JL		
PROJ. ENGR:	RJL		
BY	DATE	DESCRIPTION OF REVISIONS	APP'D

FL FREYER & LAURETA, INC.
 CIVIL ENGINEERS • SURVEYORS • CONSTRUCTION MANAGERS

144 North San Mateo Drive • San Mateo, CA 94401
 (650)344-9901 • Fax (650)344-9920 • www.freyerlaureta.com

WEST BAY SANITARY DISTRICT
 SAN MATEO COUNTY
 PROJECT No. 1758.9



ALPINE ROAD SANITARY SEWER REPLACEMENT PROJECT
PLAN & PROFILE ALPINE ROAD
STA 21+00 TO 26+50
PORTOLA VALLEY, CALIFORNIA

SHEET
6
 JOB NO.
1080

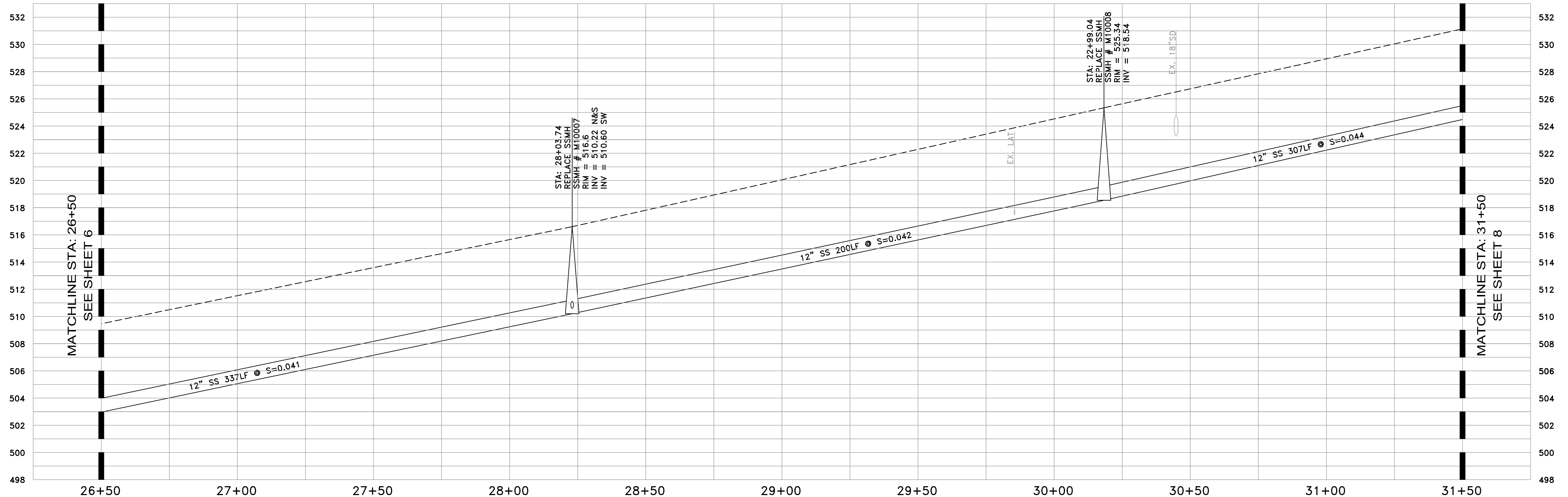
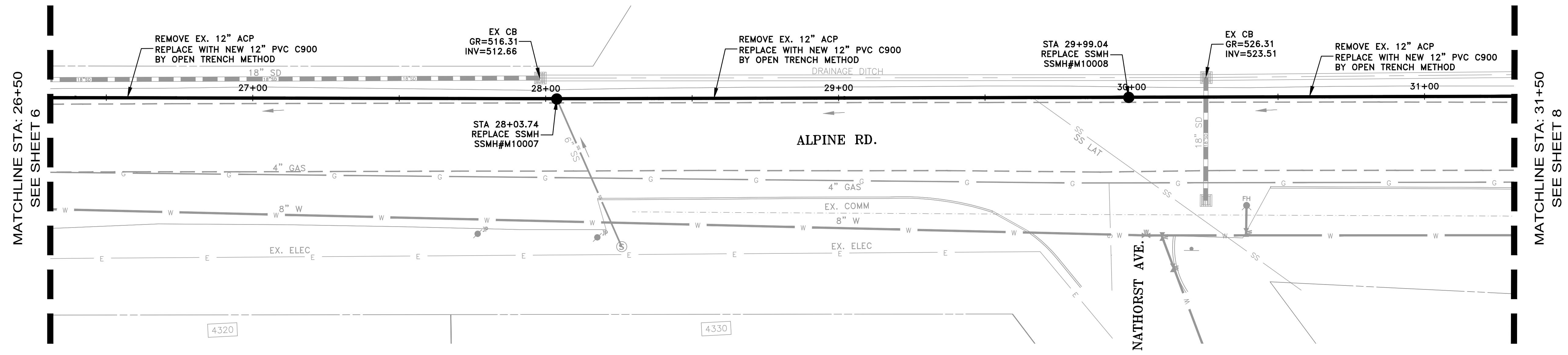

NOTES:

- 1) CONTRACTOR SHALL BE RESPONSIBLE FOR THE UNINTERRUPTION OF SEWER SERVICE FOR ALL PROPERTIES. CONTRACTOR SHALL SUBMIT BYPASS PLAN TO THE DISTRICT FOR APPROVAL 10 DAYS PRIOR TO THE PRE-CONSTRUCTION MEETING.
- 2) CONTRACTOR SHALL TAKE ALL NECESSARY PRECAUTIONS TO AVOID ANY DAMAGE TO EXISTING UTILITIES. CONTRACTOR SHALL NOTE THE CLOSE PROXIMITY OF UTILITIES TO PROPOSED IMPROVEMENTS. CONTRACTOR SHALL NOTIFY U.S.A. TO LOCATE UTILITIES AT THE PROJECT SITE PRIOR TO START OF CONSTRUCTION.
- 3) ALL LATERALS AND THEIR LOCATION MAY NOT BE EXACT AS THEY ARE REFERENCED FROM INFORMATION GIVEN BY WBSD. IT IS THE CONTRACTOR'S RESPONSIBILITY TO LOCATE THE EXACT LOCATION OF EACH PROPERTY LATERAL FOR CONNECTION.
- 4) ALL PROPERTY LINES SHOWN ARE APPROXIMATE.

STATION (FT)

PROFILE VIEW
 HORIZ: 1" = 20'
 VERT: 1" = 4'

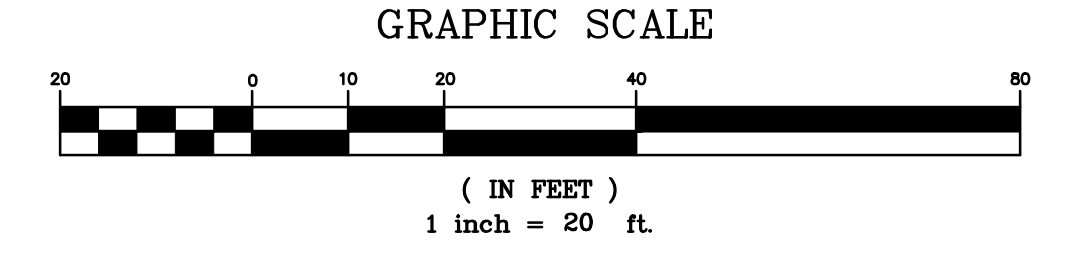
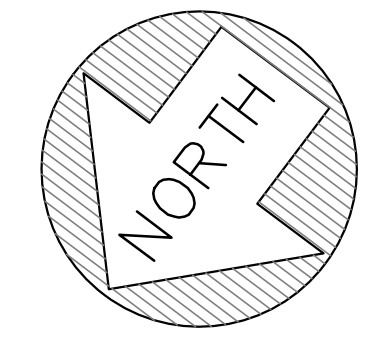

DATE:	09/11/18	09/14/18	ISSUED FOR BID
SCALE:	AS NOTED		
DESIGNED:	RQL		
DRAWN:	RQL		
CHECKED:	JL		
PROJ. ENGR:	RJL		
BY	DATE	DESCRIPTION OF REVISIONS	APP'D

FL FREYER & LAURETA, INC.
 CIVIL ENGINEERS • SURVEYORS • CONSTRUCTION MANAGERS

144 North San Mateo Drive • San Mateo, CA 94401
 (650)344-9901 • Fax (650)344-9920 • www.freyerlaureta.com

WEST BAY SANITARY DISTRICT
 SAN MATEO COUNTY
 PROJECT No. 1758.9



ALPINE ROAD SANITARY SEWER REPLACEMENT PROJECT
PLAN & PROFILE ALPINE ROAD
STA 26+50 TO 31+50
PORTOLA VALLEY, CALIFORNIA

SHEET
7
 JOB NO.
1080

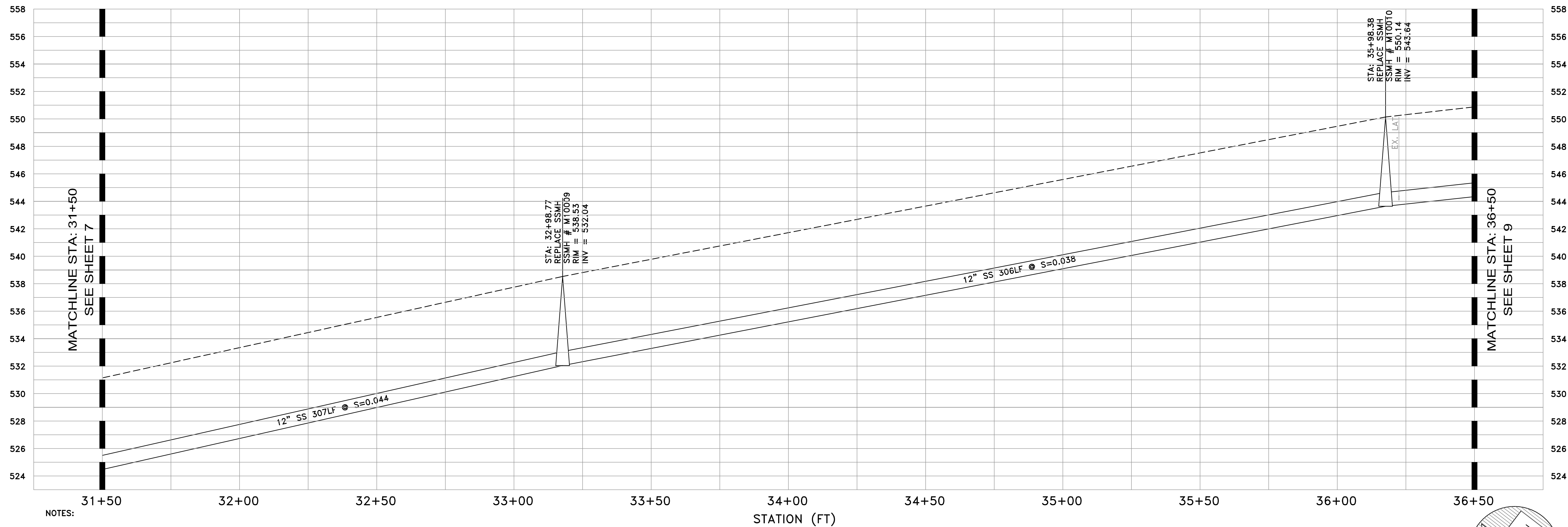
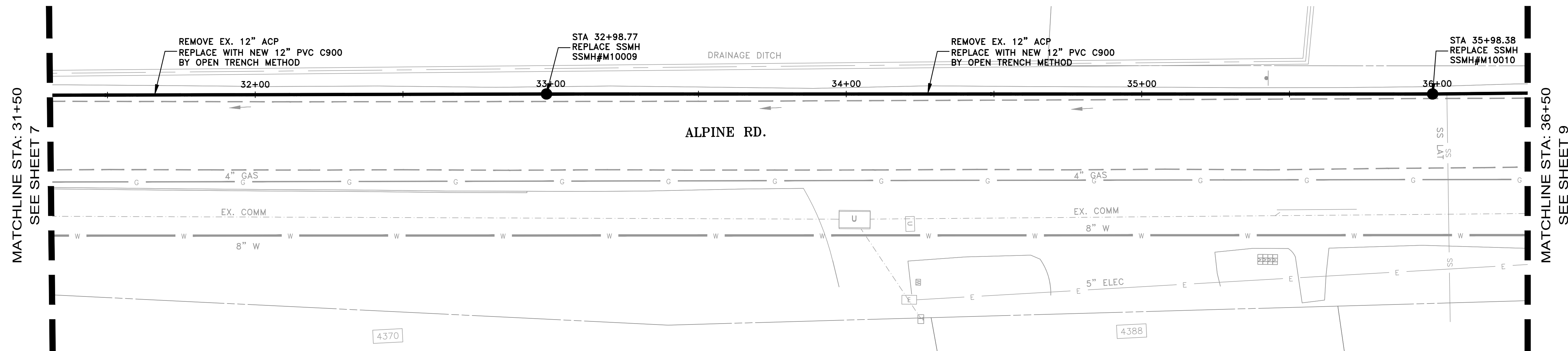

- NOTES:
- 1) CONTRACTOR SHALL BE RESPONSIBLE FOR THE UNINTERRUPTION OF SEWER SERVICE FOR ALL PROPERTIES. CONTRACTOR SHALL SUBMIT BYPASS PLAN TO THE DISTRICT FOR APPROVAL 10 DAYS PRIOR TO THE PRE-CONSTRUCTION MEETING.
 - 2) CONTRACTOR SHALL TAKE ALL NECESSARY PRECAUTIONS TO AVOID ANY DAMAGE TO EXISTING UTILITIES. CONTRACTOR SHALL NOTE THE CLOSE PROXIMITY OF UTILITIES TO PROPOSED IMPROVEMENTS. CONTRACTOR SHALL NOTIFY U.S.A. TO LOCATE UTILITIES AT THE PROJECT SITE PRIOR TO START OF CONSTRUCTION.
 - 3) ALL LATERALS AND THEIR LOCATION MAY NOT BE EXACT AS THEY ARE REFERENCED FROM INFORMATION GIVEN BY WBSD. IT IS THE CONTRACTOR'S RESPONSIBILITY TO LOCATE THE EXACT LOCATION OF EACH PROPERTY LATERAL FOR CONNECTION.
 - 4) ALL PROPERTY LINES SHOWN ARE APPROXIMATE.

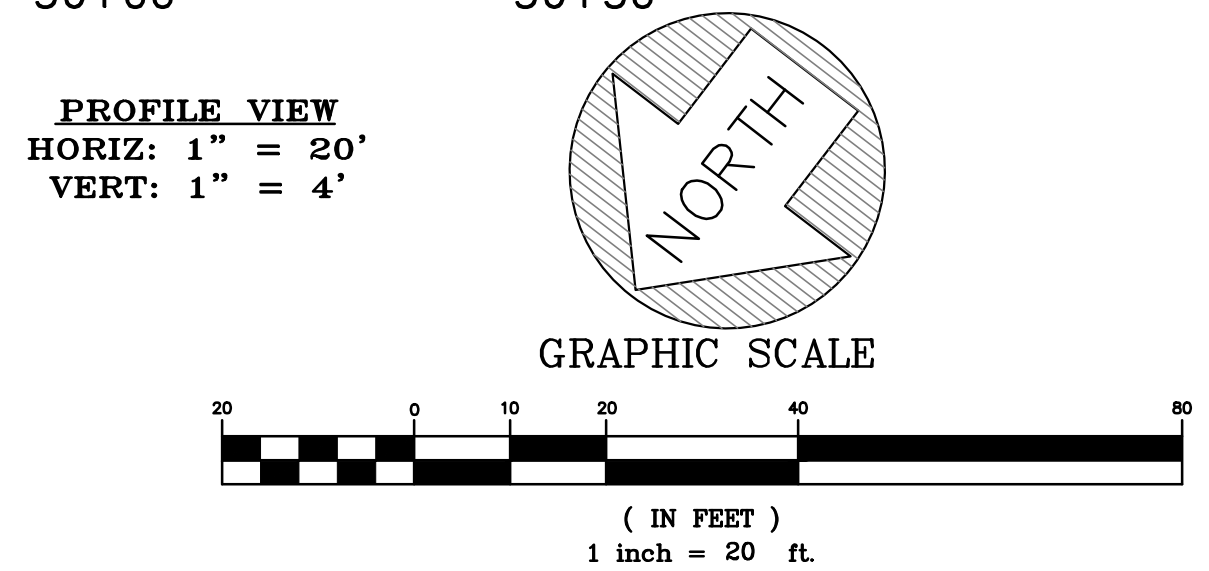

DATE:	09/11/18	09/14/18	ISSUED FOR BID
SCALE:	AS NOTED		
DESIGNED:	RQL		
DRAWN:	RQL		
CHECKED:	JL		
PROJ. ENGR:	RJL		
BY	DATE	DESCRIPTION OF REVISIONS	APP'D

FL FREYER & LAURETA, INC.
 CIVIL ENGINEERS • SURVEYORS • CONSTRUCTION MANAGERS

144 North San Mateo Drive • San Mateo, CA 94401
 (650)344-9901 • Fax (650)344-9920 • www.freyerlaureta.com

WEST BAY SANITARY DISTRICT
 SAN MATEO COUNTY
 PROJECT No. 1758.9



ALPINE ROAD SANITARY SEWER REPLACEMENT PROJECT
PLAN & PROFILE ALPINE ROAD
STA 31+50 TO 36+50
PORTOLA VALLEY, CALIFORNIA

SHEET
8
 JOB NO.
1080

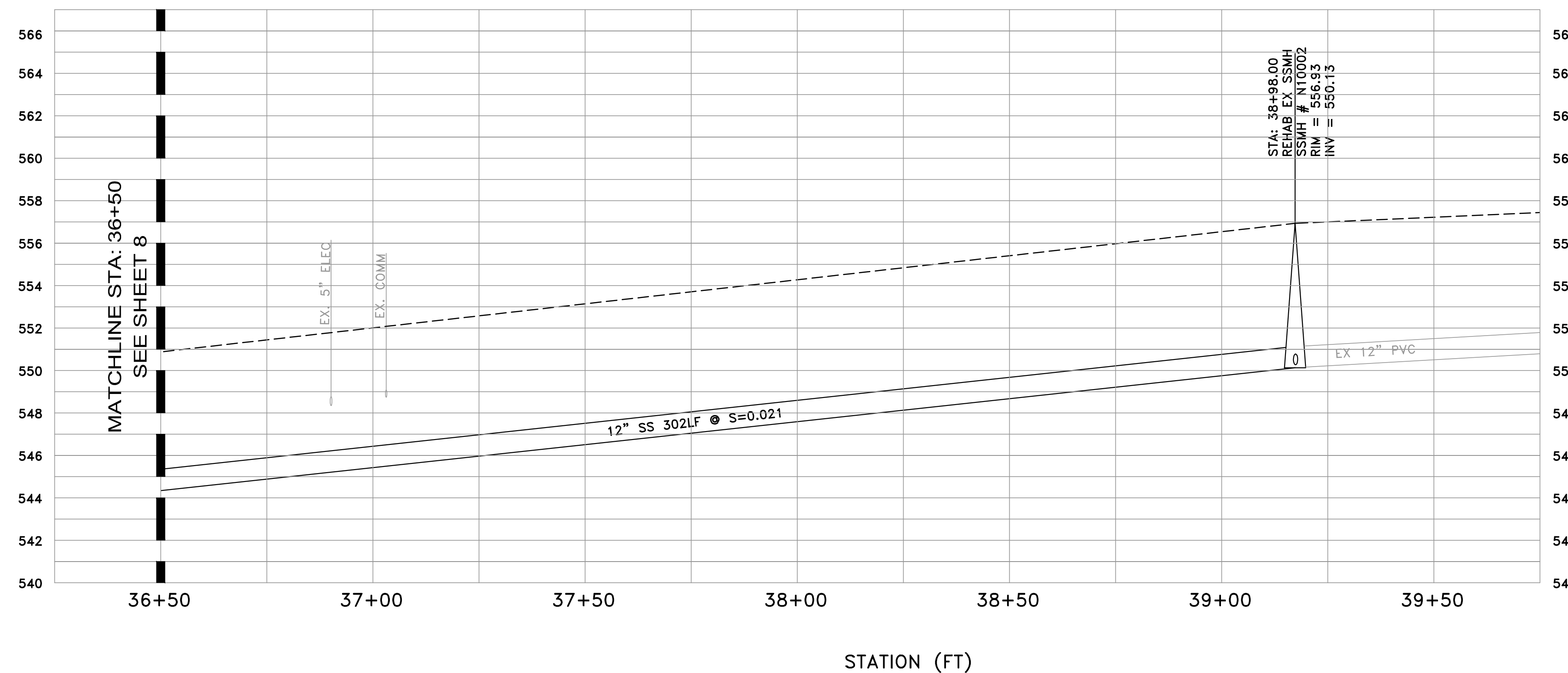
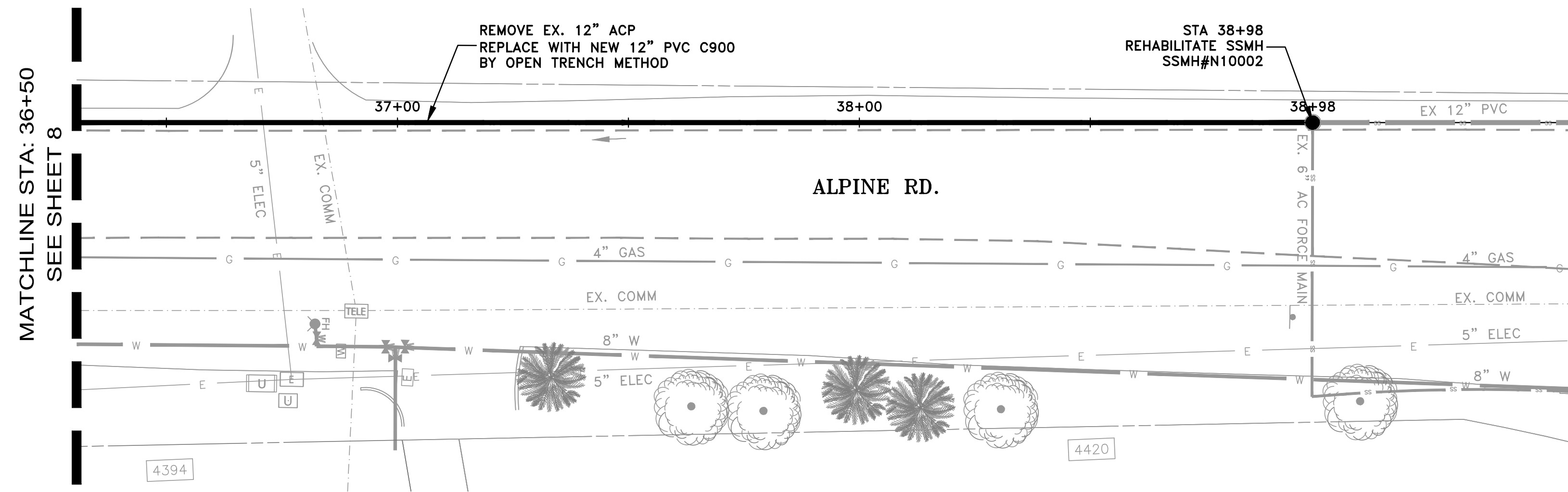

PROFILE VIEW
 HORIZ: 1" = 20'
 VERT: 1" = 4'

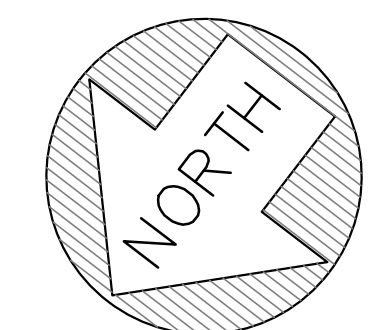

GRAPHIC SCALE

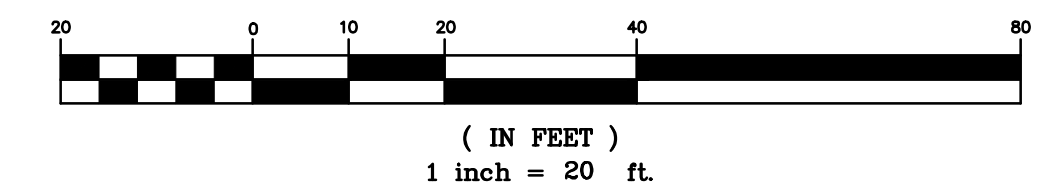

NOTES:

- 1) CONTRACTOR SHALL BE RESPONSIBLE FOR THE UNINTERRUPTION OF SEWER SERVICE FOR ALL PROPERTIES. CONTRACTOR SHALL SUBMIT BYPASS PLAN TO THE DISTRICT FOR APPROVAL 10 DAYS PRIOR TO THE PRE-CONSTRUCTION MEETING.
- 2) CONTRACTOR SHALL TAKE ALL NECESSARY PRECAUTIONS TO AVOID ANY DAMAGE TO EXISTING UTILITIES. CONTRACTOR SHALL NOTE THE CLOSE PROXIMITY OF UTILITIES TO PROPOSED IMPROVEMENTS. CONTRACTOR SHALL NOTIFY U.S.A. TO LOCATE UTILITIES AT THE PROJECT SITE PRIOR TO START OF CONSTRUCTION.
- 3) ALL LATERALS AND THEIR LOCATION MAY NOT BE EXACT AS THEY ARE REFERENCED FROM INFORMATION GIVEN BY WBSD. IT IS THE CONTRACTOR'S RESPONSIBILITY TO LOCATE THE EXACT LOCATION OF EACH PROPERTY LATERAL FOR CONNECTION.
- 4) ALL PROPERTY LINES SHOWN ARE APPROXIMATE.

DATE:	09/11/18	09/14/18	ISSUED FOR BID	
SCALE:	AS NOTED			
DESIGNED:	RQL			
DRAWN:	RQL			
CHECKED:	JL			
PROJ. ENGR:	RJL			
BY	DATE	DESCRIPTION OF REVISIONS	APP'D	

FL FREYER & LAURETA, INC.
 CIVIL ENGINEERS • SURVEYORS • CONSTRUCTION MANAGERS

144 North San Mateo Drive • San Mateo, CA 94401
 (650)344-9901 • Fax (650)344-9920 • www.freyerlaureta.com

WEST BAY
 SANITARY DISTRICT
 SAN MATEO COUNTY

PROJECT No. 1758.9

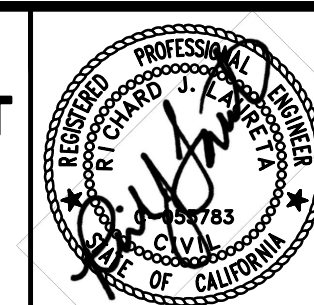

ALPINE ROAD SANITARY
SEWER REPLACEMENT PROJECT
PLAN & PROFILE ALPINE ROAD
STA 36+50 TO 38+98
PORTOLA VALLEY, CALIFORNIA

SHEET

9

JOB NO.

1080

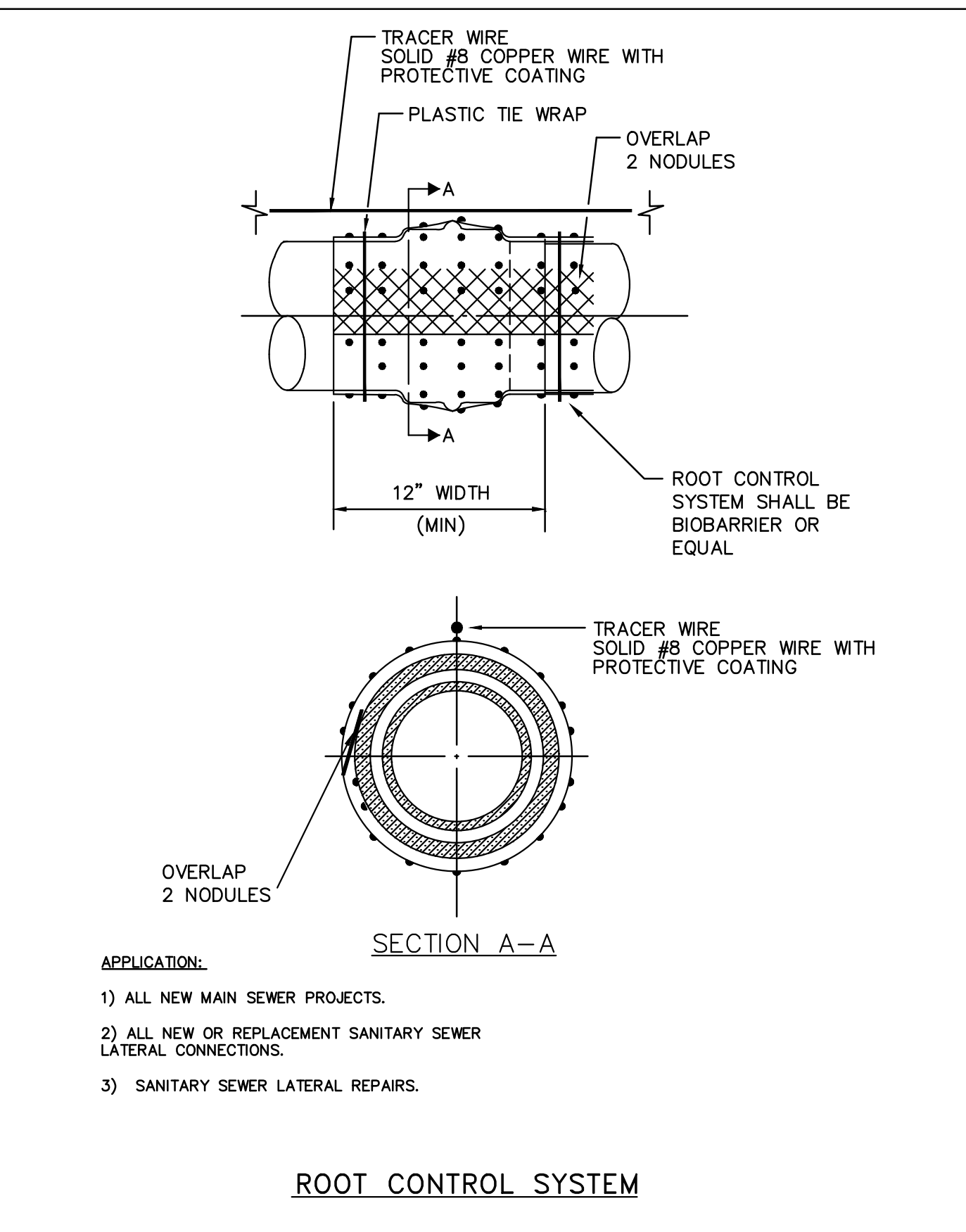
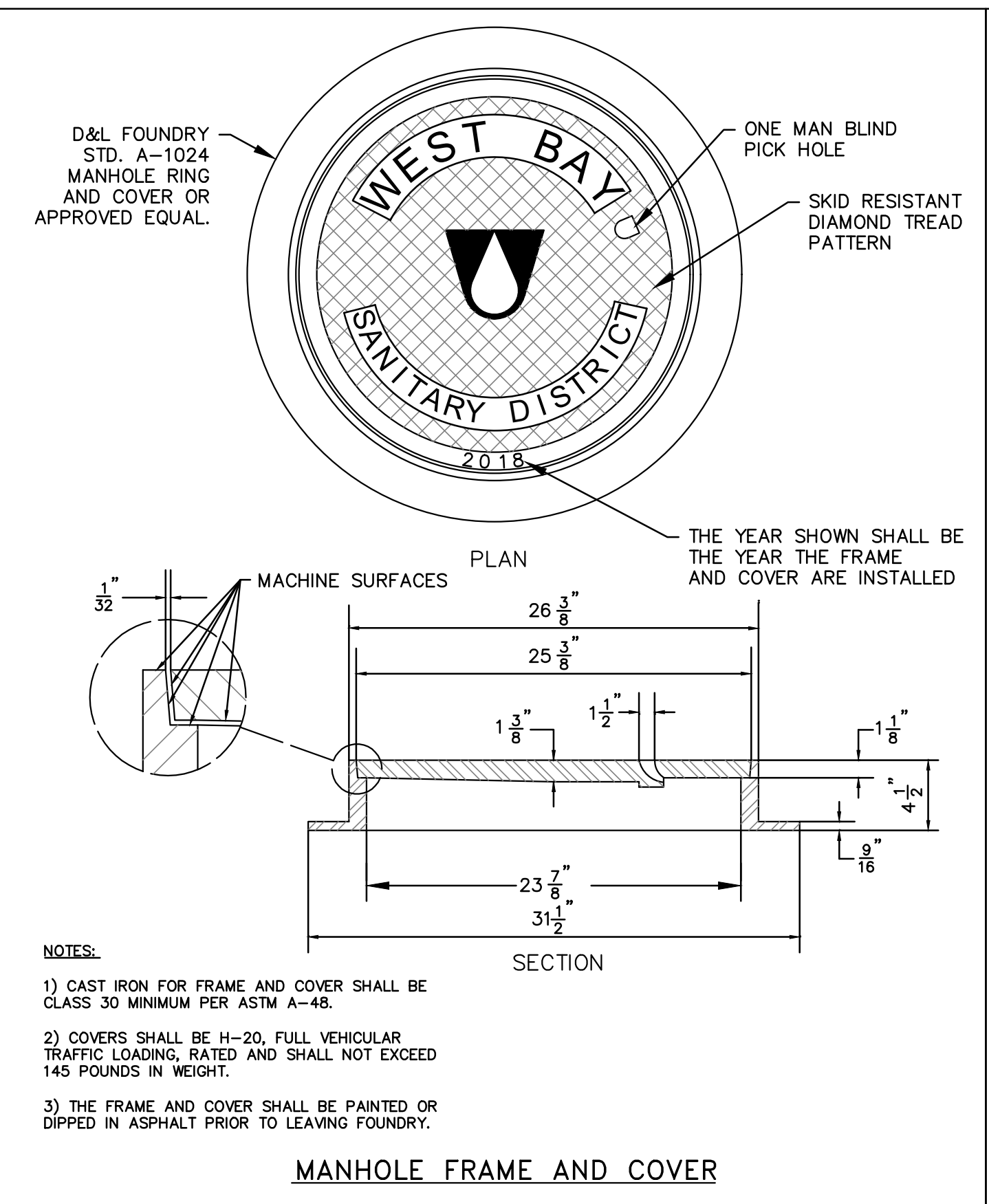
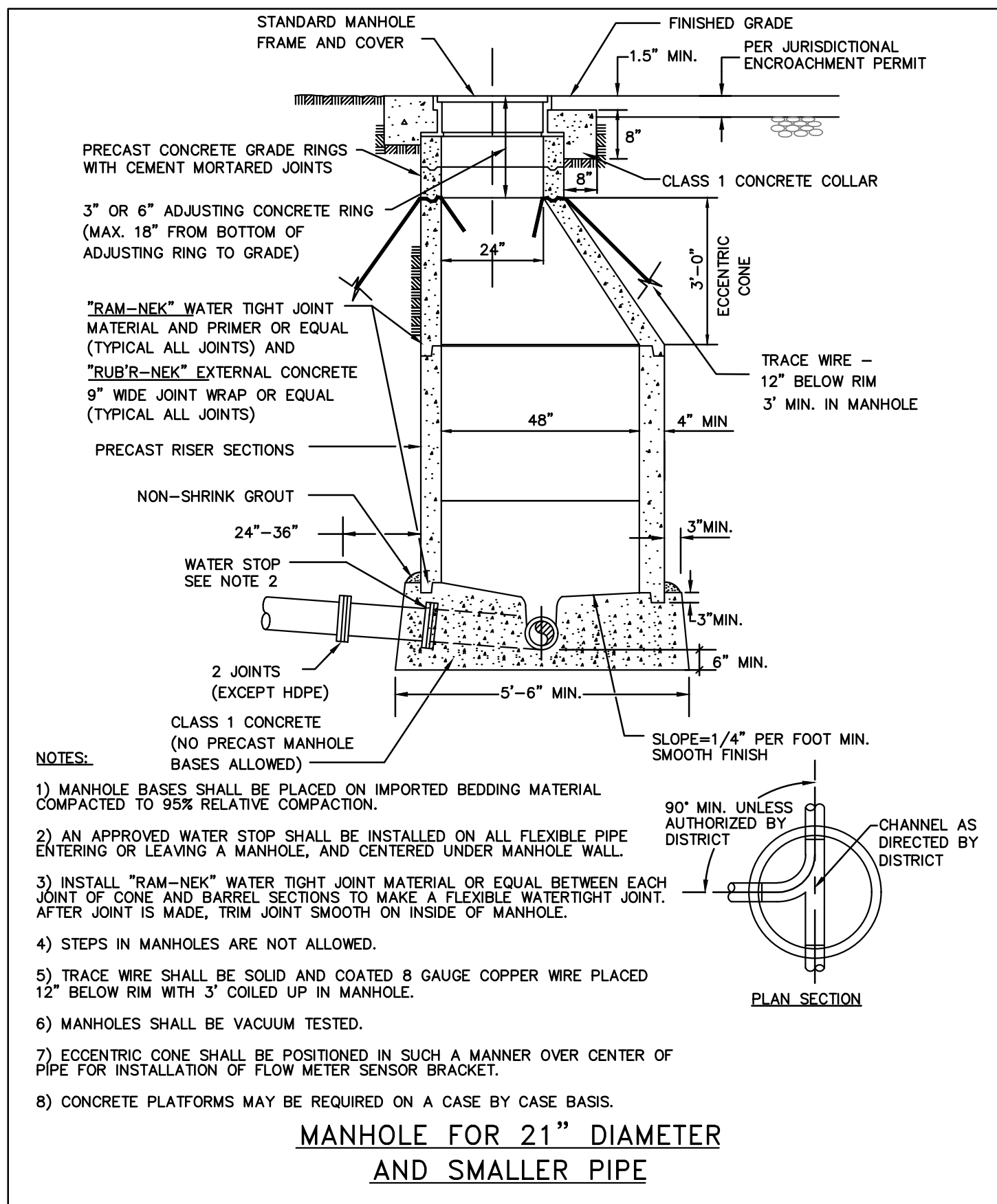

BEDDING MATERIAL

GRANULAR BEDDING MATERIAL REQUIREMENTS (ASTM D448 SIZE #67)

SIEVE SIZES	PERCENTAGE PASSING
1"	100
3/4"	90-100
3/8"	20-55
#4	0-10
#8	0-5

CONTROL DENSITY FILL

THE MIX DESIGN FOR CDF SHALL MEET THE FOLLOWING REQUIREMENTS:

CEMENT	50-100 LB/CU. YD
FLY ASH, CLASS F	10-2000 LB/CU. YD
FINE AGGREGATE	2600-3100 LB/CU. YD
WATER	325/580 LB/CU. YD
STRENGTH @ 28 DAY	50-100 PSI

STRUCTURAL BACKFILL MATERIAL

STRUCTURAL BACKFILL MATERIAL: MATERIAL WITH SAND EQUIVALENT NOT LESS THAN 20 AND SIEVE GRADATION BY MATERIAL AS FOLLOWS:

SIEVE SIZE	% PASSING SIEVE
75mm (3")	100
No. 4	35-100
No. 30	20-100

1. TEMPORARY PAVEMENT SHALL BE PLACED IN UNPLATED TRENCHES AT THE END OF EACH DAY. MATERIAL SHALL BE HIGH QUALITY PATCH MIX SUCH AS "GRANIEPATCH", "QUICKPATCH", OR "DUROPATCH". CUTBACK SHALL NOT BE USED IN STREET AREAS FOR TEMPORARY PATCHING.
2. PERMANENT SURFACE RESTORATION SHALL BE INSTALLED NO SOONER THAN 10 DAYS AND NO MORE THAN 25 WORKING DAYS AFTER TEMPORARY SURFACE IS FIRST PUT IN PLACE.
3. CONTRACTOR SHALL BE RESPONSIBLE FOR REPLACING ANY STRIPING REMOVED DURING TRENCHING.

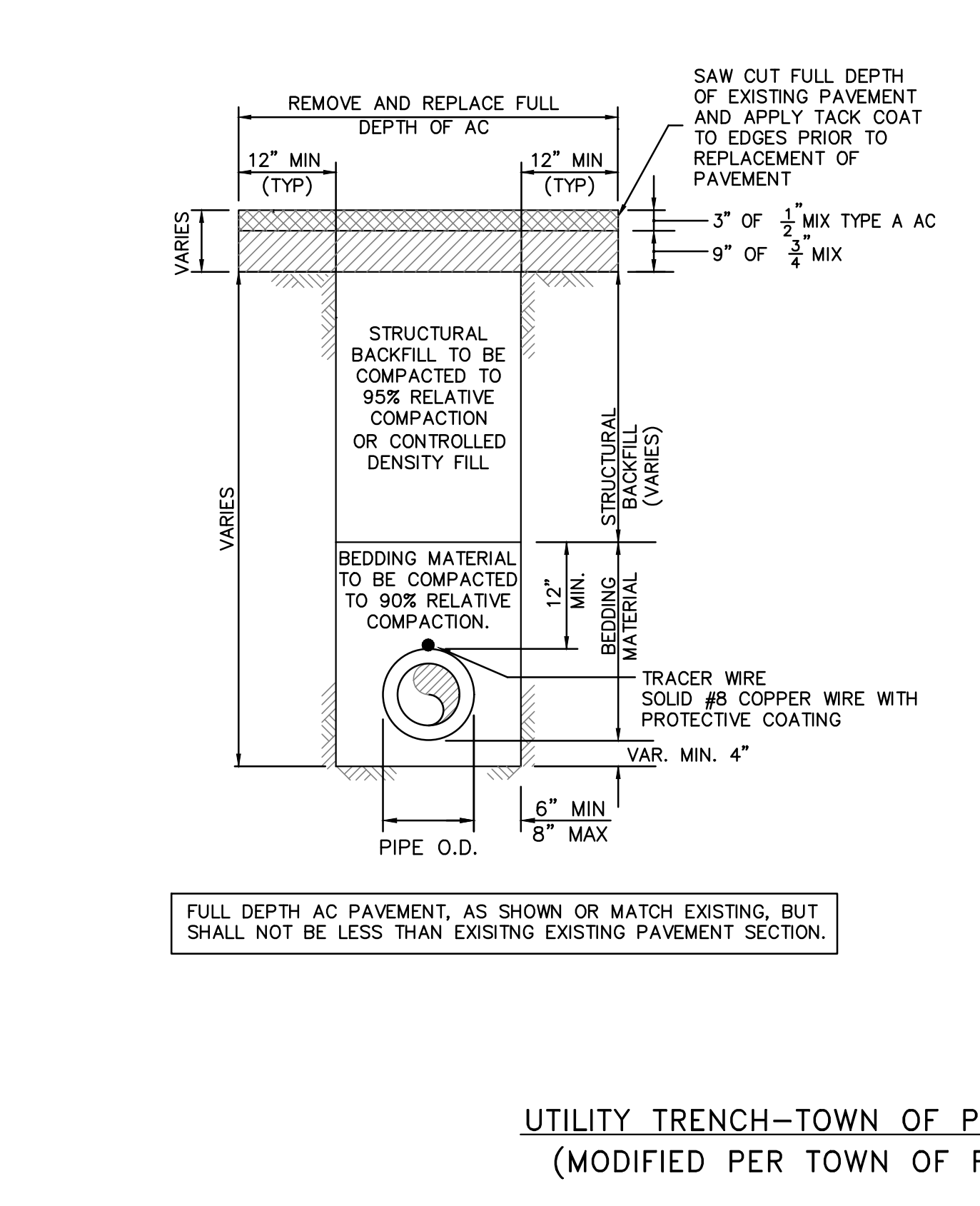
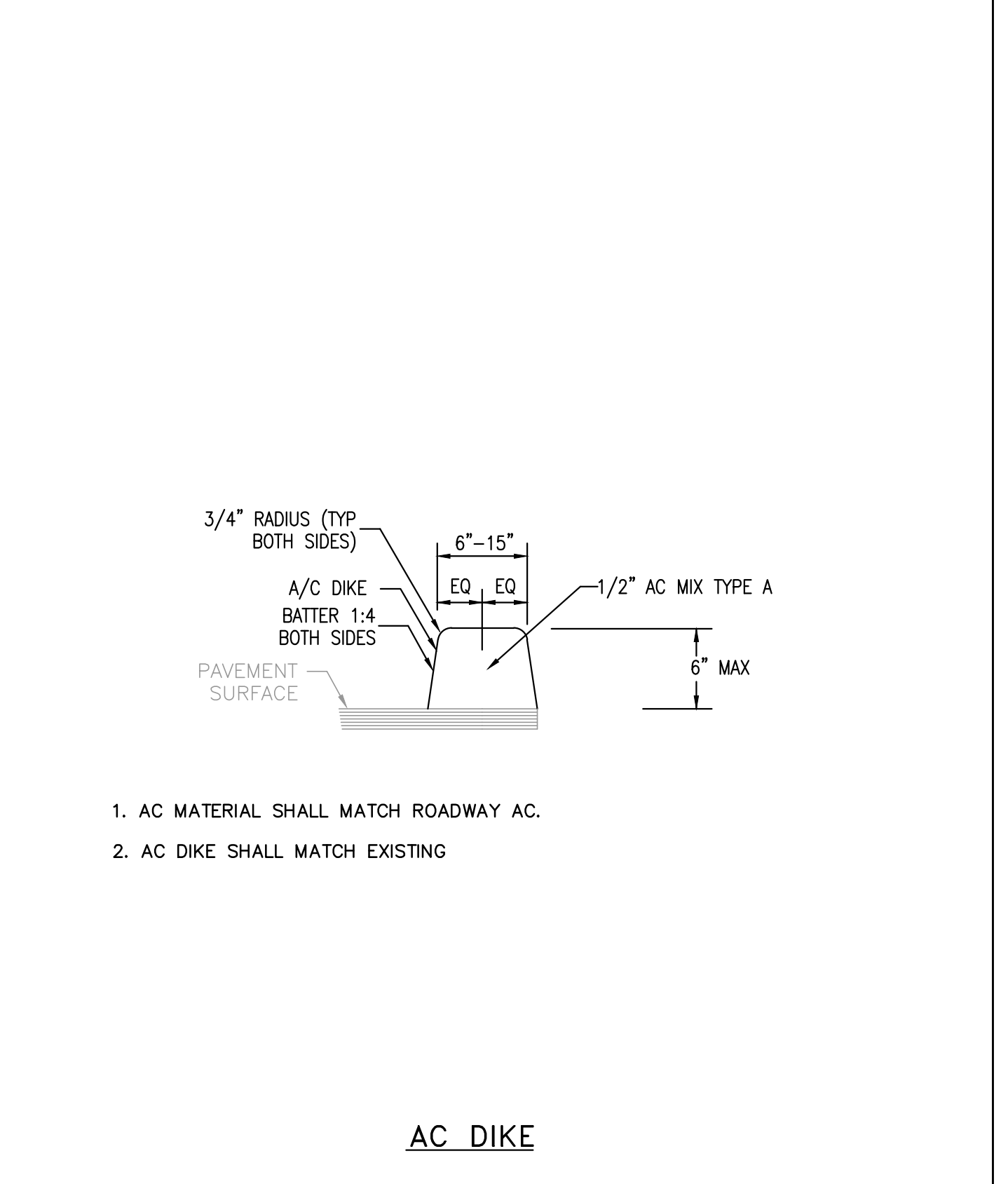
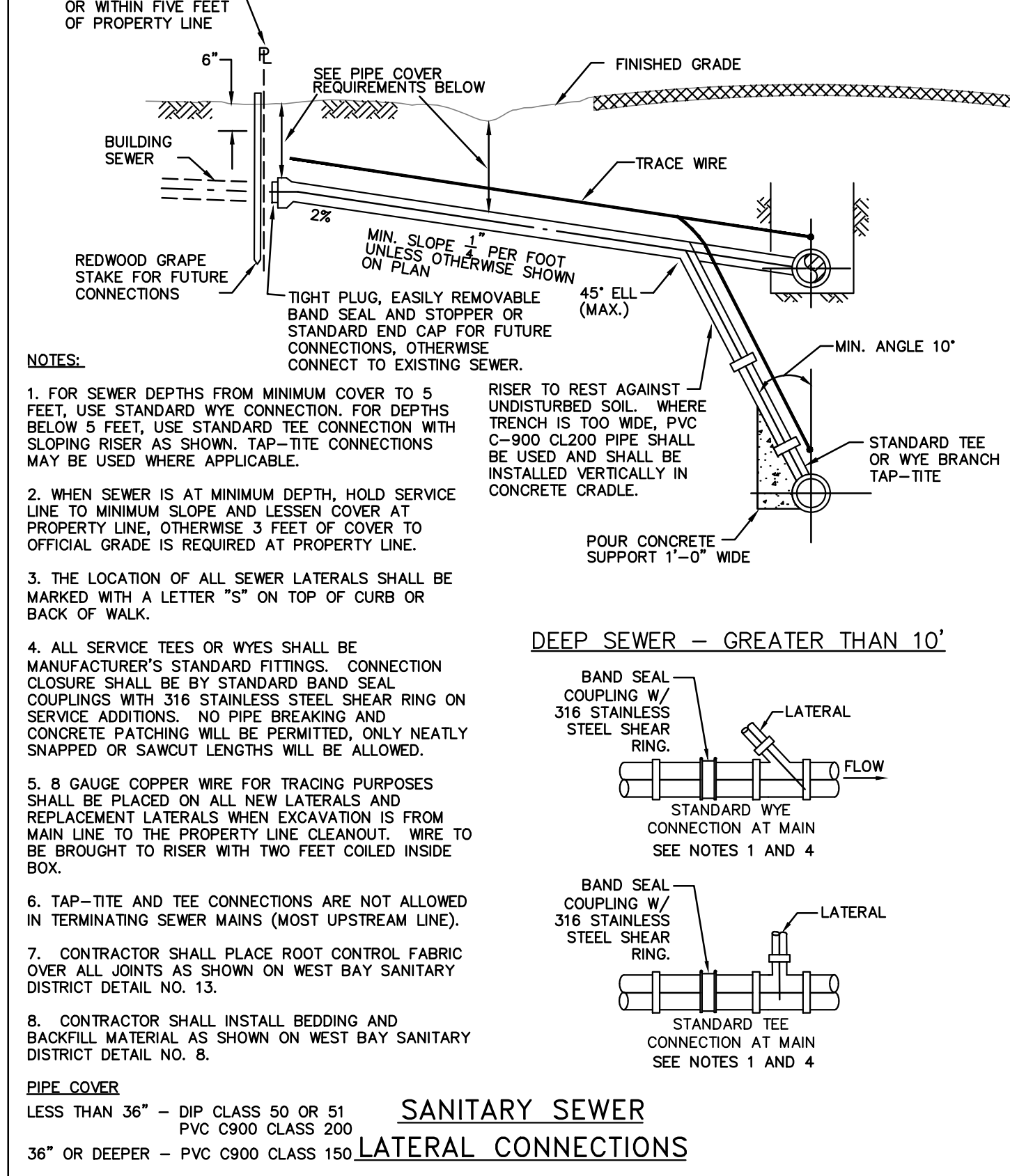

BEDDING MATERIAL

GRANULAR BEDDING MATERIAL REQUIREMENTS (ASTM D448 SIZE #67)

SIEVE SIZES	PERCENTAGE PASSING
1"	100
3/4"	90-100
3/8"	20-55
#4	0-10
#8	0-5

CONTROL DENSITY FILL

THE MIX DESIGN FOR CDF SHALL MEET THE FOLLOWING REQUIREMENTS:

CEMENT	50-100 LB/CU. YD
FLY ASH, CLASS F	10-2000 LB/CU. YD
FINE AGGREGATE	2600-3100 LB/CU. YD
WATER	325/580 LB/CU. YD
STRENGTH @ 28 DAY	50-100 PSI

STRUCTURAL BACKFILL MATERIAL

STRUCTURAL BACKFILL MATERIAL: MATERIAL WITH SAND EQUIVALENT NOT LESS THAN 20 AND SIEVE GRADATION BY MATERIAL AS FOLLOWS:

SIEVE SIZE	% PASSING SIEVE
75mm (3")	100
No. 4	35-100
No. 30	20-100

1. TEMPORARY PAVEMENT SHALL BE PLACED IN UNPLATED TRENCHES AT THE END OF EACH DAY. MATERIAL SHALL BE HIGH QUALITY PATCH MIX SUCH AS "GRANIEPATCH", "QUICKPATCH", OR "DUROPATCH". CUTBACK SHALL NOT BE USED IN STREET AREAS FOR TEMPORARY PATCHING.
2. PERMANENT SURFACE RESTORATION SHALL BE INSTALLED NO SOONER THAN 10 DAYS AND NO MORE THAN 25 WORKING DAYS AFTER TEMPORARY SURFACE IS FIRST PUT IN PLACE.
3. CONTRACTOR SHALL BE RESPONSIBLE FOR REPLACING ANY STRIPING REMOVED DURING TRENCHING.

DATE:	09/11/18	09/14/18	ISSUED FOR BID
SCALE:	AS NOTED		
DESIGNED:	RQL		
DRAWN:	RQL		
CHECKED:	JL		
PROJ. ENGR:	RJL		
BY	DATE	DESCRIPTION OF REVISIONS	APP'D

FREYER & LAURETA, INC.
CIVIL ENGINEERS • SURVEYORS • CONSTRUCTION MANAGERS

144 North San Mateo Drive • San Mateo, CA 94401
(650)344-9901 • Fax (650)344-9920 • www.freyerlaureta.com

WEST BAY SANITARY DISTRICT
SAN MATEO COUNTY
PROJECT No. 1758.9

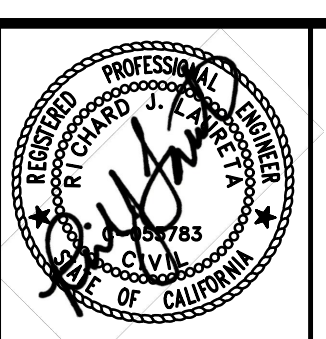

ALPINE ROAD SANITARY SEWER REPLACEMENT PROJECT
DETAIL SHEET #1
PORTOLA VALLEY, CALIFORNIA

SHEET	10
JOB NO.	1080

Construction Best Management Practices (BMPs)

Construction projects are required to implement the stormwater best management practices (BMP) on this page, as they apply to your project, all year long.

Materials & Waste Management

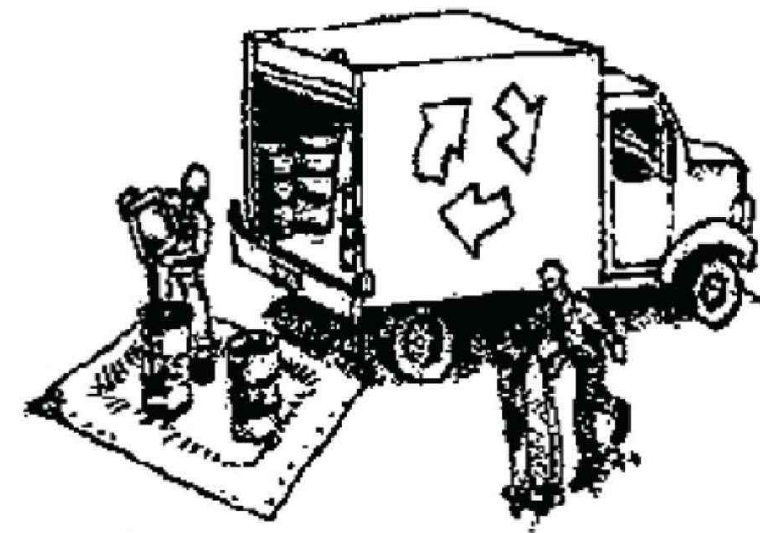

Non-Hazardous Materials

- Berm and cover stockpiles of sand, dirt or other construction material with tarps when rain is forecast or if not actively being used within 14 days.
- Use (but don't overuse) reclaimed water for dust control.

Hazardous Materials

- Label all hazardous materials and hazardous wastes (such as pesticides, paints, thinners, solvents, fuel, oil, and antifreeze) in accordance with city, county, state and federal regulations.
- Store hazardous materials and wastes in water tight containers, store in appropriate secondary containment, and cover them at the end of every work day or during wet weather or when rain is forecast.
- Follow manufacturer's application instructions for hazardous materials and be careful not to use more than necessary. Do not apply chemicals outdoors when rain is forecast within 24 hours.
- Arrange for appropriate disposal of all hazardous wastes.

Waste Management

- Cover waste disposal containers securely with tarps at the end of every work day and during wet weather.
- Check waste disposal containers frequently for leaks and to make sure they are not overfilled. Never hose down a dumpster on the construction site.
- Clean or replace portable toilets, and inspect them frequently for leaks and spills.
- Dispose of all wastes and debris properly. Recycle materials and wastes that can be recycled (such as asphalt, concrete, aggregate base materials, wood, gyp board, pipe, etc.)
- Dispose of liquid residues from paints, thinners, solvents, glues, and cleaning fluids as hazardous waste.

Construction Entrances and Perimeter

- Establish and maintain effective perimeter controls and stabilize all construction entrances and exits to sufficiently control erosion and sediment discharges from site and tracking off site.
- Sweep or vacuum any street tracking immediately and secure sediment source to prevent further tracking. Never hose down streets to clean up tracking.

Equipment Management & Spill Control



Maintenance and Parking

- Designate an area, fitted with appropriate BMPs, for vehicle and equipment parking and storage.
- Perform major maintenance, repair jobs, and vehicle and equipment washing off site.
- If refueling or vehicle maintenance must be done onsite, work in a bermed area away from storm drains and over a drip pan or drop cloths big enough to collect fluids. Recycle or dispose of fluids as hazardous waste.
- If vehicle or equipment cleaning must be done onsite, clean with water only in a bermed area that will not allow rinse water to run into gutters, streets, storm drains, or surface waters.
- Do not clean vehicle or equipment onsite using soaps, solvents, degreasers, or steam cleaning equipment.

Spill Prevention and Control

- Keep spill cleanup materials (e.g., rags, absorbents and cat litter) available at the construction site at all times.
- Inspect vehicles and equipment frequently for and repair leaks promptly. Use drip pans to catch leaks until repairs are made.
- Clean up spills or leaks immediately and dispose of cleanup materials properly.
- Do not hose down surfaces where fluids have spilled. Use dry cleanup methods (absorbent materials, cat litter, and/or rags).
- Sweep up spilled dry materials immediately. Do not try to wash them away with water, or bury them.
- Clean up spills on dirt areas by digging up and properly disposing of contaminated soil.
- Report significant spills immediately. You are required by law to report all significant releases of hazardous materials, including oil. To report a spill: 1) Dial 911 or your local emergency response number, 2) Call the Governor's Office of Emergency Services Warning Center, (800) 852-7550 (24 hours).

Earthmoving

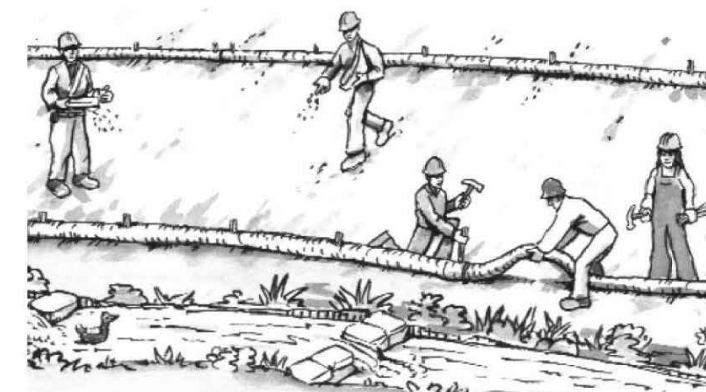

- Schedule grading and excavation work during dry weather.
- Stabilize all denuded areas, install and maintain temporary erosion controls (such as erosion control fabric or bonded fiber matrix) until vegetation is established.
- Remove existing vegetation only when absolutely necessary, and seed or plant vegetation for erosion control on slopes or where construction is not immediately planned.
- Prevent sediment from migrating offsite and protect storm drain inlets, gutters, ditches, and drainage courses by installing and maintaining appropriate BMPs, such as fiber rolls, silt fences, sediment basins, gravel bags, berms, etc.
- Keep excavated soil on site and transfer it to dump trucks on site, not in the streets.

Contaminated Soils

- If any of the following conditions are observed, test for contamination and contact the Regional Water Quality Control Board:
 - Unusual soil conditions, discoloration, or odor.
 - Abandoned underground tanks.
 - Abandoned wells
 - Buried barrels, debris, or trash.

Paving/Asphalt Work



- Avoid paving and seal coating in wet weather or when rain is forecast, to prevent materials that have not cured from contacting stormwater runoff.
- Cover storm drain inlets and manholes when applying seal coat, tack coat, slurry seal, fog seal, etc.
- Collect and recycle or appropriately dispose of excess abrasive gravel or sand. Do NOT sweep or wash it into gutters.
- Do not use water to wash down fresh asphalt concrete pavement.

Sawcutting & Asphalt/Concrete Removal

- Protect nearby storm drain inlets when saw cutting. Use filter fabric, catch basin inlet filters, or gravel bags to keep slurry out of the storm drain system.
- Shovel, absorb, or vacuum saw-cut slurry and dispose of all waste as soon as you are finished in one location or at the end of each work day (whichever is sooner!).
- If sawcut slurry enters a catch basin, clean it up immediately.

Concrete, Grout & Mortar Application



- Store concrete, grout, and mortar away from storm drains or waterways, and on pallets under cover to protect them from rain, runoff, and wind.
- Wash out concrete equipment/trucks offsite or in a designated washout area, where the water will flow into a temporary waste pit, and in a manner that will prevent leaching into the underlying soil or onto surrounding areas. Let concrete harden and dispose of as garbage.
- When washing exposed aggregate, prevent washwater from entering storm drains. Block any inlets and vacuum gutters, hose washwater onto dirt areas, or drain onto a bermed surface to be pumped and disposed of properly.

Landscaping

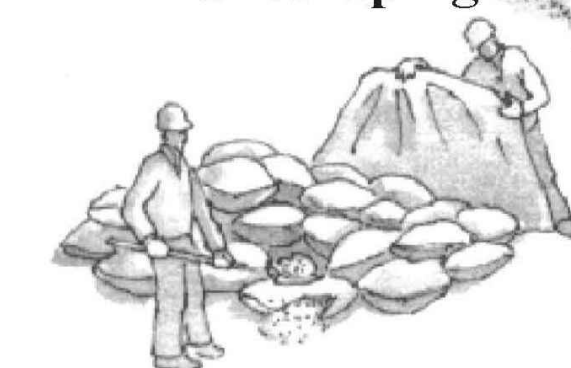

- Protect stockpiled landscaping materials from wind and rain by storing them under tarps all year-round.
- Stack bagged material on pallets and under cover.
- Discontinue application of any erodible landscape material within 2 days before a forecast rain event or during wet weather.

Painting & Paint Removal

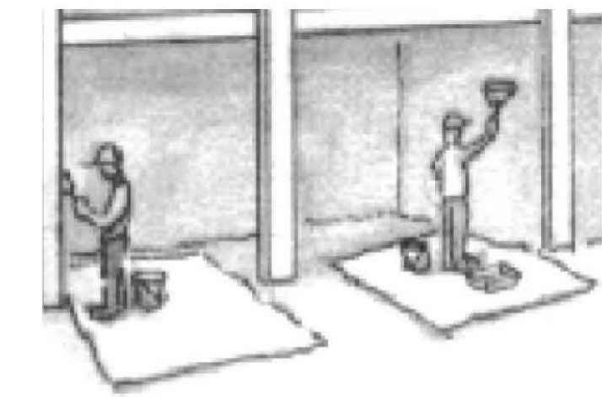

Painting Cleanup and Removal

- Never clean brushes or rinse paint containers into a street, gutter, storm drain, or stream.
- For water-based paints, paint out brushes to the extent possible, and rinse into a drain that goes to the sanitary sewer. Never pour paint down a storm drain.
- For oil-based paints, paint out brushes to the extent possible and clean with thinner or solvent in a proper container. Filter and reuse thinners and solvents. Dispose of excess liquids as hazardous waste.
- Paint chips and dust from non-hazardous dry stripping and sand blasting may be swept up or collected in plastic drop cloths and disposed of as trash.
- Chemical paint stripping residue and chips and dust from marine paints or paints containing lead, mercury, or tributyltin must be disposed of as hazardous waste. Lead based paint removal requires a state-certified contractor.

Dewatering

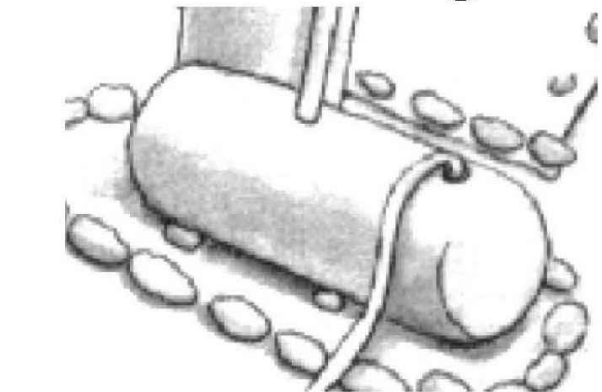

- Discharges of groundwater or captured runoff from dewatering operations must be properly managed and disposed. When possible send dewatering discharge to landscaped area or sanitary sewer. If discharging to the sanitary sewer call your local wastewater treatment plant.
- Divert run-on water from offsite away from all disturbed areas.
- When dewatering, notify and obtain approval from the local municipality before discharging water to a street gutter or storm drain. Filtration or diversion through a basin, tank, or sediment trap may be required.
- In areas of known or suspected contamination, call your local agency to determine whether the ground water must be tested. Pumped groundwater may need to be collected and hauled off-site for treatment and proper disposal.

Storm drain polluters may be liable for fines of up to \$10,000 per day!

DATE:	09/11/18	09/14/18	ISSUED FOR BID	
SCALE:	AS NOTED			
DESIGNED:	RQL			
DRAWN:	RQL			
CHECKED:	JL			
PROJ. ENGR:	RJL			
BY	DATE	DESCRIPTION OF REVISIONS	APP'D	

FL FREYER & LAURETA, INC.
CIVIL ENGINEERS • SURVEYORS • CONSTRUCTION MANAGERS

144 North San Mateo Drive • San Mateo, CA 94401
(650)344-9901 • Fax (650)344-9920 • www.freyerlaureta.com

**WEST BAY
SANITARY DISTRICT
SAN MATEO COUNTY**

PROJECT No. 1758.9



**ALPINE ROAD SANITARY
SEWER REPLACEMENT PROJECT
CONSTRUCTION BEST MANAGEMENT PRACTICES
PORTOLA VALLEY, CALIFORNIA**

SHEET
11
JOB NO.
1080